



kumar properties &lt;kumarworldcompliance2025@gmail.com&gt;

---

## Six Monthly Compliance Report for period April 2022 to September 2022 for project \_Prakruti Constructions Pvt. Ltd.

---

kumar properties &lt;kumarworldcompliance2025@gmail.com&gt;

Thu, Dec 1, 2022 at 12:29 PM

To: ecompliance-mh@gov.in

Bcc: Moef19@kumarworld.com

Dear Sir/Madam,

Please find the Post EC Compliance Report attached herewith for Period April 2022 to September 2022 of Residential project proposed on\_ F.P. no.105, S. no. 343/2, Tadiwala Road, Haveli, Pune, Maharashtra. , by Prakruti Constructions Pvt. Ltd.,with reference to Environmental Clearance Letter No. SEIAA-EC-0000002051 dated 22<sup>nd</sup> October 2019.

Hope this is in line with your requirement.

Thanking you  
Yours Sincere

Prakruti Constructions Pvt. Ltd.



---

**Compliance report\_Pinacal\_April 2022 to September 2022.pdf**

15734K



## PRAKRUTI CONSTRUCTIONS PVT. LTD.

REGISTERED ADDRESS : 21, HAZARIMAL SOMANI MARG, WAUDBY ROAD, OPP. BOMBAY GYMKHANA, FORT, MUMBAI - 400 001. TEL : 022-2209 4876 / 2209 4797  
CORP. OFF. ADDRESS : KUMAR CAPITAL, 2413, EAST STREET, CAMP, PUNE - 411 001. TEL : 020 - 3052 8888 / 3058 3635  
E-mail : contact@kumarworld.com Website : www.kumarworld.com CIN : U45200MH1993PTC075778

**Date: - 30/11/2022**

**To**  
**The Chairman, SEIAA,**  
Environment Department,  
15<sup>th</sup> Floor, New Administrative Building,  
Mantralaya, Mumbai-400032.

**Sub:** Post EC Compliance Report for the Period of April 2022 to September 2022 of our Residential and Commercial Project at F.P. no.105, S. no. 343/2, Tadiwala Road, Haveli, Pune, Maharashtra by Prakruti Constructions Pvt. Ltd.

**Ref.:** Environmental Clearance Letter No. SEIAA-EC-0000002051 dated 22nd October 2019.

Dear Sir/Madam

As per the condition laid down in the Environmental Clearance Letter, we are submitting herewith post EC compliance report of our Residential and Commercial Project for the period of April 2022 to September 2022.

Hope this is in line with your requirement.

Thanking you

For **Prakruti Constructions Pvt. Ltd.**

**CC:** ✓ **1. MPCB -The Member Secretary, Kalpataru Point, 3<sup>rd</sup> and 4<sup>th</sup> floor,**  
**Opp. Cine Planet, Sion Circle, Sion, Mumbai, Maharashtra 400022.**

**Mail: MoEF- Regional Office, (WCZ), Ground floor, East Wing, New Secretariat Building, Civil Lines Nagpur-440001.**

5-12-2022.

**महाराष्ट्र प्रदूषण नियंत्रण मंडळ**  
कल्पतरु पॉइंट, २ रा मजला, सायन सर्कल,  
सिनेप्लेनेट समोरा, सायन (पूर्व),  
मुंबई - ४०० ०२२.  
फोन :- २४०९०४३७ / २४०२०७८९  
Website www.mpcb.gov.in

**SIX MONTHLY COMPLIANCE REPORT**

**OF**

**‘RESIDENTIAL & COMMERCIAL PROJECT’**

**AT**

**F.P.NO. 105, S. NO. 343/2, TADIWALA ROAD**

**PUNE,**

**BEING DEVELOPED BY**

**PRAKRUTI CONSTRUCTIONS PVT. LTD.**

**FOR**

**APRIL 2022 TO SEPTEMBER 2022**

### TABLE OF CONTENTS

<b>Sections</b>	<b>Particulars</b>
Section 1	Purpose of the Report
Section 2	Project Details
Section 3	Present Site Conditions
Section 4	Post Environment Clearance Compliance Report
Section 5	Monitoring and Analysis

### LIST OF ANNEXURES

<b>Annexures</b>	<b>Particulars</b>
Annexure 1	Environment Clearance Letter
Annexure 2	SWACH NOC
Annexure 3	Sanction layout
Annexure 4	Consent to Establish
Annexure 5	Monitoring Reports
Annexure 6	Water NOC, Drainage, Fire NOC & Society Registration Certificate
Annexure 7	Budgetary provision for EMP
Annexure 8	Advertisement Copy
Annexure 9	Acknowledgement of EC submission copy to Local Authority
Annexure 10	Previously submitted Six Monthly Compliance report Acknowledgement copies
Annexure 11	Copy of Submitted Environmental Statement for financial year April 2021 to March 2022

## Section1: Purpose of the Report

As per the 'Sub Para (i)' of 'Para 10' of EIA Notification 2006 and Condition mentioned and in General condition for construction phase in Sr. No. XLI and LIII of Environmental Clearance (EC) letter (SEIAA-EC-0000002051) dated 22<sup>nd</sup> October 2019 (**Annexure 1**), it is mandatory to submit six monthly compliance report to show the status & compliance of all the conditions mentioned in EC letter, along with monitoring of various environmental parameters. Therefore, based on specific and general conditions mentioned in EC letter detail compliance report is prepared.

## Section 2: Project Details

Prakruti Constructions Pvt. Ltd. is constructing residential at F.P.no. 105, S. no. 343/2, Tadiwala Road, Haveli, Pune, Maharashtra. The project is designed as a self-sufficient establishment wherein infrastructure facilities such as water supply, power supply and communication facilities are proposed. Further the project proponent has made provision for waste collection and disposal, rain water harvesting and sewage treatment to ensure that project is environment friendly. The project proponent also proposes arrangement for safety; maintenance and security of residents. The main features of the project are as follows.

Sr. No.	Particulars	Details
1	Total Plot Area (As per EC)	12943.86 m <sup>2</sup>
2	Construction BUA (FSI + Non FSI)	25389.07 m <sup>2</sup>
3	Total Water Requirement	208 m <sup>3</sup> /day
4	Recycled Water Requirement (For Flushing & Landscaping)	Flushing: 19 m <sup>3</sup> /day Landscaping: 7 m <sup>3</sup> /day
6	Sewage Generation	181 m <sup>3</sup> /day
7	No. & Capacity of STP	1 no. with capacity of 55 KLD
8	Solid Waste Generation	Non-Bio-degradable Waste: 317 kg/day Bio-degradable Waste: 446 kg/day
9	Energy Demand	During Construction Phase: (Demand Load): - 116 kVA During Operation Phase: (Connected Load): - 1565 KW During Operation Phase: (Demand Load): - 790 kVA DG Set: 1 no. x 140 kVA & 1 no. x 125 kVA Transformers - 630 kVA X 2 nos.

**Section 3: Present Site Conditions**

Sr. No.	Name of Buildings	No. of Buildings	Current Status
1.	A1, A2, A3, A6 & Club House	05 Buildings	Completed & handed over to society.
2.	A4, A5	02 Buildings	Proposed

Sr. No.	Status	Construction Area (in Sq.m)
1.	Total Construction Area as per EC	25389.07
2.	Total Construction Area Completed till September 2022	18630.13

**Section 4: Post Environment Clearance Compliance Report**

The Application was considered by the State Level Expert Appraisal Committee-III. The proposal has been considered by SEIAA in its 177<sup>th</sup> meeting held on 3<sup>rd</sup> October, 2019 and accorded Environmental Clearance for the above-mentioned project under the provisions of the Environment Impact Assessment Notification, 2006 and amendments thereto and Circulars issued thereon and subject to the compliance of the following specific conditions, in addition to the general conditions mentioned below:

Sr. No.	EC Conditions	Compliance Status
<b><u>Specific Conditions</u></b>		
i.	PP to submit CER plan to Municipal Commissioner/District Collector and submit the acknowledgement to Member Secretary, SEIAA	We have submitted CER plan to Municipal Commissioner on 23/09/2019 and acknowledgement copy of the same has been uploaded on EC MPCB portal on 23/06/2020. But as per OM No. F.No.22-65/2017/IA.III dt. 30.09.20, CER is not applicable.
ii.	PP Shall comply with Standard EC conditions mentioned in the Office Memorandum issued by MoEF & CC vide F.No.22-34/2018-IA.III dt.04.01.2019.	Yes, We will comply the standard EC conditions mentioned in the Office Memorandum issued by MoEF & CC vide F.No.22-34/2018-IA.III dt.04.01.2019
iii	SEIAA decided to grant EC for –FSI: 16540.30	We agreed to this Condition.

	m <sup>2</sup> , Non-FSI: 8848.77 m <sup>2</sup> and Total BUA: 25389.07 m <sup>2</sup> ( Plan Approval no-CC/4056/18 DPO/Zone no.4 Date- 27.03.2019)	
	<b><u>General Conditions</u></b>	
i.	E-waste shall be disposed through Authorized vendor as per E-waste (Management and Handling) Rules, 2016.	An Agreement with SWACH is made for disposal of dry waste & E-waste and copy of same is attached as an <b>Annexure 2</b>
ii.	The Occupancy Certificate shall be issued by the Local Planning Authority to the project only after ensuring sustained availability of drinking water, connectivity of sewer line to the project site and proper disposal of treated water as per environmental norms.	Condition is noted and informed to local body.
iii.	This environmental clearance is issued subject to obtaining NOC from Forestry & Wild life angle including clearance from the standing committee of the National Board for Wild life as if applicable & this environment clearance does not necessarily imply that Forestry & Wild life clearance granted to the project which will be considered separately on merit.	No NOC is required from the Forestry & Wildlife board as there is no forest land in the vicinity.
iv.	PP has to abide by the conditions stipulated by SEAC& SEIAA.	Yes, we will abide by conditions stipulated by SEAC and SEIAA.
v.	The height, Construction built up area of proposed construction shall be in accordance with the existing FSI/FAR norms of the urban local body & it should ensure the same along with survey number before approving layout plan & before according commencement certificate to proposed work. Plan approving authority should also ensure the zoning permissibility for the proposed project as per the approved development plan of the area.	The height, Construction built up area of proposed construction is in accordance with the existing FSI/FAR norms of the urban local body. Proposed project is in the residential zone as per the approved development plan of the area. The construction will be as per Commencement vide no.CC/4056/18 D.P.O/ Zone no. 4 dated 27/03/2019. A copy of same is attached as <b>Annexure 3.</b>
vi.	If applicable Consent for Establishment shall be obtained from Maharashtra Pollution Control Board under Air and Water Act and a copy shall	'Consent for Establishment' (No. format1.0/BO/JD(WPC)/UAN-084659/CE/CC-2006000665)



	be submitted to the Environment department before start of any construction work at the site.	obtained dated 15.06.2020 from MPCB. Copy of same is attached as <b>Annexure 4.</b>
vii.	All required sanitary and hygienic measures should be in place before starting construction activities and to be maintained throughout the construction phase	Sanitary facilities such as toilets for ladies and Gents will be provided on site and water for drinking purpose will be provided on site.
viii.	Adequate drinking water and sanitary facilities should be provided for construction workers at the site. Provision should be made for mobile toilets. The safe disposal of wastewater and solid wastes generated during the construction phase should be ensured.	Drinking water will be provided for laborers on site, Waste water generated will be disposed of through urinals connected with septic tank, Solid waste generated will be treated in OWC.
ix.	The solid waste generated should be properly collected and segregated. dry/inert solid waste should be disposed off to the approved sites for land filling after recovering recyclable material.	The solid waste will be segregated and recyclable material will be sold to recyclers and inert material will be used for site leveling.
x.	Disposal of muck during construction phase should not create any adverse effect on the neighboring communities and be disposed taking the necessary precautions for general safety and health aspects of people, only in approved sites with the approval of competent authority.	All construction waste will be collected and segregated properly at site and most of it will be reuse for construction activity and we will ensure that no neighboring community will get affected.
xi.	Arrangement shall be made that waste water and storm water do not get mixed.	Waste water will be treated in STP & treated water will be reused within the project for landscaping & flushing and excess water will be discharge to drainage. Maximum storm water will be recharge through recharge pits and excess storm water will be drain through municipal storm water line. Hence we ensured that waste water and storm water will not get mixed.
xii.	All the topsoil excavated during construction activities should be stored for use in horticulture / landscape development within the project site.	We will use top soil for landscape development.
xiii.	Additional soil for leveling of the proposed site shall be generated within the sites (to the extent possible) so that natural drainage system of the	Construction debris will be used for base preparation of the road and for site leveling.



	area is protected and improved.	
xiv.	Green Belt Development shall be carried out considering CPCB guidelines including selection of plant species and in consultation with the local DFO/ Agriculture Dept.	Condition noted and will be complied with.
xv.	Soil and ground water samples will be tested to ascertain that there is no threat to ground water quality by leaching of heavy metals and other toxic contaminants.	Soil testing was done, according to reports all the parameters are within limit and so there is no threat to ground water quality by leaching of heavy metals and other toxic contaminants, Monitoring reports are attached as <b>Annexure 5.</b>
xvi.	Construction spoils, including bituminous material and other hazardous materials must not be allowed to contaminate watercourses and the dumpsites for such material must be secured so that they should not leach into the ground water	We will take proper measures during construction activity to avoid contamination of water courses. No bituminous material will be used in construction.
xvii.	Any hazardous waste generated during construction phase should be disposed off as per applicable rules and norms with necessary approvals of the Maharashtra Pollution Control Board.	Used oil generated at site will be disposed of through MPCB authorized vendors.
xviii.	The diesel generator sets to be used during construction phase should be low sulphur diesel type and should conform to Environment (Protection) Rules prescribed for air and noise emission standards.	We will use low sulphur diesel type DG during construction phase and it will confirm to Environment (Protection) rules prescribed for Air and Noise emission standards.
xix.	The diesel required for operating DG sets shall be stored in underground tanks and if required, clearance from concern authority shall be taken	We will be using DG set only during power failure and hence not much diesel will be stored at site.
xx.	Vehicles hired for bringing construction material to the site should be in good condition and should have a pollution check certificate and should conform to applicable air and noise emission standards and should be operated only during non-peak hours.	Construction vehicles will be checked for PUC certificate before entry.

xxi.	Ambient noise levels should conform to residential standards both during day and night. Incremental pollution loads on the ambient air and noise quality should be closely monitored during construction phase. Adequate measures should be made to reduce ambient air and noise level during construction phase, so as to conform to the stipulated standards by CPCB/MPCB.	Care will be taken to maintain the noise level within limits at site. Construction activities will be limited to daytime only. Noise shields will be provided for heavy construction equipments. PPE will also be provided to labours.
xxii.	Fly ash should be used as building material in the construction as per the provisions of Fly Ash Notification of September 1999 and amended as on 27th August, 2003. (The above condition is applicable only if the project site is located within the 100Km of Thermal Power Stations).	NA as the site is away from Thermal Power Stations. Still, we will be using Fly Ash Bricks for our construction.
xxiii.	Ready mixed concrete must be used in building construction.	Yes, we will use Ready mixed concrete in construction.
xxiv	Storm water control and its re-use as per CGWB and BIS standards for various applications.	We will achieve it.
xxv	Water demand during construction should be reduced by use of pre-mixed concrete, curing agents and other best practices referred.	We will use tanker water for construction. Still we will reduce the water demand during construction by adopting suggested measures.
xxvi	The ground water level and its quality should be monitored regularly in consultation with Ground Water Authority.	Condition is noted.
xxvii	The installation of the Sewage Treatment Plant (STP) should be certified by an independent expert and a report in this regard should be submitted to the MPCB and Environment department before the project is commissioned for operation. Discharge of this unused treated effluent, if any should be discharge in the sewer line. Treated effluent emanating from STP shall be recycled/refused to the maximum extent possible. Discharge of this unused treated affluent, if any should be discharge in the sewer	1 STP of capacity 55 KLD will be provided for proposed buildings. The treated sewage will be used for flushing & gardening purpose in proposed buildings. Discharge of unused treated affluent shall conform to the norms of MPCB.

	line. Treatment of 100% gray water by decentralized treatment should be done. Necessary measures should be made to mitigate the odour problem from STP.	
xxviii	Permission to draw ground water and construction of basement if any shall be obtained from the competent Authority prior to construction/operation of the project.	We will not use ground water. In case of requirement we will obtain permission to withdraw ground water from competent authority.
xxix	Separation of gray and black water should be done by the use of dual plumbing line for separation of gray and black water.	100% of wastewater will be treated in the proposed STP.
xxx	Fixtures for showers, toilet flushing and drinking should be of low flow either by use of aerators or pressure reducing devices or sensor based control.	We will use low flow fixtures in toilets to minimize wastage of water.
xxxi	Use of glass may be reduced up to 40% to reduce the electricity consumption and load on air conditioning. If necessary, use high quality double glass with special reflective coating in windows.	We will keep use of glass below 40%.
xxxii	Roof should meet prescriptive requirement as per Energy Conservation Building Code by using appropriate thermal insulation material to fulfill requirement.	Condition is noted.
xxxiii	Energy conservation measures like installation of CFLs /TFLs for the lighting the areas outside the building should be integral part of the project design and should be in place before project commissioning. Use CFLs and TFLs should be properly collected and disposed off/sent for recycling as per the prevailing guidelines/rules of the regulatory authority to avoid mercury contamination. Use of solar panels may be done to the extent possible like installing solar street lights, common solar water heaters system. Project proponent should install, after checking feasibility, solar plus hybrid non-conventional energy source as source of energy.	Condition is noted. We are using CFLs in Common area. We shall also be using Solar energy for our proposed buildings.

xxxiv	Diesel power generating sets proposed as source of backup power for elevators and common area illumination during operation phase should be of enclosed type and conform to rules made under the Environment (Protection) Act, 1986. The height of stack of DG sets should be equal to the height needed for the combined capacity of all proposed DG sets. Use low sulphur diesel. The location of the DG sets may be decided with in consultation with Maharashtra Pollution Control Board.	DG set of capacity 1 no. x 140 kVA & 1 no. x 125 kVA will be provided for power back up. DG sets will be provided with silencer and acoustic enclosures. Stack shall be provided as per MPCB norms.
xxxv	Noise should be controlled to ensure that it does not exceed the prescribed standards. During nighttime the noise levels measured at the boundary of the building shall be restricted to the permissible levels to comply with the prevalent regulations.	Yes we will maintain noise level as per standards norms.
xxxvi	Traffic congestion near the entry and exit points from the roads adjoining the proposed project site must be avoided. Parking should be fully internalized and no public space should be utilized.	Condition is noted
xxxvii	Opaque wall should meet prescriptive requirement as per Energy Conservation Building Code, which is proposed to be mandatory for all air-conditioned spaces while it is aspiration for non-air-conditioned spaces by use of appropriate thermal insulation material to fulfill requirement.	Condition is noted
xxxviii	The building should have adequate distance between them to allow movement of fresh air and passage of natural light, air and ventilation.	Condition is noted
xxxix	Regular supervision of the above and other measures for monitoring should be in place all through the construction phase, so as to avoid disturbance to the surroundings.	Construction not yet started. Dedicated site engineer and supervisory staff will be appointed to take care of the monitoring and overall implementation

XL	Under the provisions of Environment (Protection) Act, 1986, legal action shall be initiated against the project proponent if it was found that construction of the project has been started without obtaining environmental clearance.	Condition is noted
XLI	Six monthly monitoring reports should be submitted to the Regional office MoEF, Bhopal with copy to this department and MPCB.	RO shifted to Nagpur hence we will submit to Nagpur.
XLII	Project proponent shall ensure completion of STP, MSW disposal facility, green belt development prior to occupation of the buildings. As agreed during the SEIAA meeting, PP to explore possibility of utilizing excess treated water in the adjacent area for gardening before discharging it into sewer line No physical occupation or allotment will be given unless all above said environmental infrastructure is installed and made functional including water requirement in Para 2. Prior certification from appropriate authority shall be obtained.	Water NOC, Drainage, Fire NOC & Society Registration certificate is attached as <b>Annexure 6</b>
XLIII	Wet garbage should be treated by Organic Waste Converter and treated waste (manure) should be utilized in the existing premises for gardening. And, no wet garbage will be disposed outside the premises. Local authority should ensure this.	OWC of capacity 300 kg/day is provided for existing buildings for treatment of wet waste.
XLIV	Local body should ensure that no occupation certification is issued prior to operation of STP/MSW site etc. with due permission of MPCB.	Condition is noted
XLV	A complete set of all the documents submitted to Department should be forwarded to the Local authority and MPCB.	Condition is noted.
XLVI	In the case of any change(s) in the scope of the project, the project would require a fresh appraisal by this Department.	In case we will cross BUA given in the EC we will take prior revised EC

XLVII	A separate environment management cell with qualified staff shall be set up for implementation of the stipulated environmental safeguards.	Environment Management Cell will be prepared for implementation of the environmental safeguards.
XLVIII	Separate funds shall be allocated for implementation of environmental protection measures/EMP along with item-wise breaks-up. These costs shall be included as part of the project cost. The funds earmarked for the environment protection measures shall not be diverted for other purposes and year-wise expenditure should reported to the MPCB & this department.	Separate funds have been allocated for implementation of environmental protection measures/EMP, copy of same is attached as <b>Annexure 7</b>
XLIX	The project management shall advertise at least in two local newspapers widely circulated in the region around the project, one of which shall be in the Marathi language of the local concerned within seven days of issue of this letter, informing that the project has been accorded environmental clearance and copies of clearance letter are available with the Maharashtra Pollution Control Board and may also be seen at Website at <a href="http://ec.maharashtra.gov.in">http://ec.maharashtra.gov.in</a> .	Advertisement was published in Marathi and English Newspaper. The copy of same is attached as <b>Annexure 8</b> .
L	Project management should submit half yearly compliance reports in respect of the stipulated prior environment clearance terms and conditions in hard & soft copies to the MPCB & this department, on 1 <sup>st</sup> June & 1st December of each calendar year.	New norms as per RO being followed.
LI	A copy of the clearance letter shall be sent by proponent to the concerned Municipal Corporation and the local NGO, if any, from whom suggestions/representations, if any, were received while processing the proposal. The clearance letter shall also be put on the website of the Company by the proponent.	A copy of Environment Clearance letter is submitted to Municipal Corporation. Copy of same is attached as <b>Annexure 9</b> .
LII	The proponent shall upload the status of compliance of the stipulated EC conditions, including results of monitored data on their	Condition is noted.

	website and shall update the same periodically. It shall simultaneously be sent to the Regional Office of MoEF, the respective Zonal Office of CPCB and the SPCB. The criteria pollutant levels namely; SPM, RSPM. SO <sub>2</sub> , NO <sub>x</sub> (ambient levels as well as stack emissions) or critical sector parameters, indicated for the project shall be monitored and displayed at a convenient location near the main gate of the company in the public domain.	
LIII	The project proponent shall also submit six monthly reports on the status of compliance of the stipulated EC conditions including results of monitored data (both in hard copies as well as by e-mail) to the respective, Regional Office of MoEF, the respective Zonal Office of CPCB and the SPCB.	Yes, we are complying this. Previously submitted six monthly report acknowledgement copies are attached as <b>Annexure 10</b> .
LIV	The environmental statement for each financial year ending 31st March in Form-V as is mandated to be submitted by the project proponent to the concerned State Pollution Control Board as prescribed under the Environment (Protection) Rules, 1986, as amended subsequently, shall also be put on the website of the company along with the status of compliance of EC conditions and shall also be sent to the respective Regional Offices of MoEF by e-mail.	We have submitted Environmental Statement for financial year April 2021 to March 2022 having UAN no.- MPCB-ENVIRONMENT_STATEMENT-0000050945 dated 19-10-2022. Copy of same is attached as <b>Annexure 11</b>
4.	The environmental clearance is being issued without prejudice to the action initiated under EP Act or any court case pending in the court of law and it does not mean that project proponent has not violated any environmental laws in the past and whatever decision under EP Act or of the Hon'ble court will be binding on the project proponent. Hence this clearance does not give immunity to the project proponent in the case filed against him, if any or action initiated under	Condition is noted.



	EP Act.	
5.	In case of submission of false document and non-compliance of stipulated conditions, Authority/ Environment Department will revoke or suspend the Environment clearance without any intimation and initiate appropriate legal action under Environmental Protection Act, 1986.	Condition is noted.
6.	The Environment department reserves the right to add any stringent condition or to revoke the clearance if conditions stipulated are not implemented to the satisfaction of the department or for that matter, for any other administrative reason.	Condition is noted.
7.	Validity of Environment Clearance: The environmental clearance accorded shall be valid as per EIA Notification, 2006, and amendments by MoEF&CC Notification dated 29 <sup>th</sup> April, 2015.	Condition is noted.
8.	In case of any deviation or alteration in the project proposed from those submitted to this department for clearance, a fresh reference should be made to the department to assess the adequacy of the condition(s) imposed and to incorporate additional environmental protection measures required, if any.	Condition is noted.
9.	The above stipulations would be enforced among others under the Water (Prevention and Control of Pollution) Act, 1974, the Air (Prevention and Control of Pollution) Act, 1981, the Environment (Protection) Act, 1986 and rules there under, Hazardous Wastes (Management and Handling) Rules, 1989 and its amendments, the public Liability Insurance Act, 1991 and its amendments.	Condition is noted.

10.	Any appeal against this Environment clearance shall lie with the National Green Tribunal (Western Zone Bench, Pune), New Administrative Building, 1st Floor, D-, Wing, Opposite Council Hall, Pune, if preferred, within 30 days as prescribed under Section 16 of the National Green Tribunal Act, 2010.	Condition is noted.
-----	---	---------------------

### Section 5: Monitoring and Analysis

Monitoring of Air quality, Water quality, Soil quality, Noise level at construction site.

Monitoring was done and samples were collected as per standard norms. All samples were analyzed in NABL accredited laboratory. The details of sampling parameters were given in following table.

Sr. No.	Environmental Components	Monitoring Parameters
1	Air	PM <sub>10</sub> , PM <sub>2.5</sub> , SO <sub>2</sub> , NO <sub>2</sub> , O <sub>3</sub> , Pb, CO, NH <sub>3</sub> , C <sub>6</sub> H <sub>6</sub> , Benzo (a) Pyrene – Particulate Phase only, As, Ni
2	Water	Colour, Odour, Turbidity, pH, TDS, Total Alkalinity, Total Hardness, Ca, Mg, Cl <sup>-</sup> , SO <sub>4</sub> , NO <sub>3</sub> , Fe, Mn, F, Pb, Cu, Zn, Cr <sup>6+</sup> , As, B, Residual Chlorine, Al, Cd, Se, Hg, Pesticides, Mineral Oil
3	Noise	Leq
4	Soil	pH, Electrical Conductivity, Total Nitrogen as N, Phosphate as P, Potassium as K, Exchangeable Calcium as Ca, Exchangeable Magnesium as Mg, Exchangeable Sodium as Na, Organic Matter, Texture

Monitoring results are attached as **Annexure 5** which indicates that parameters of all environmental components are within standard limit and there is no pollution at site.



# STATE LEVEL ENVIRONMENT IMPACT ASSESSMENT AUTHORITY

Environment department,  
Room No. 217, 2nd floor,  
Mantralaya, Annexe,  
Mumbai- 400 032.  
Date: October 22, 2019

To,  
**Prakruti Constructions Pvt. Ltd.**  
at F.P.no. 105, S. no. 343/2, Tadiwala Road

**Subject:** Environment Clearance for Proposed Residential project by Prakruti Constructions Pvt Ltd at F.P.no. 105, S. no. 343/2, Tadiwala Road, Sangamwadi, Pune, Maharashtra

Sir,

This has reference to your communication on the above mentioned subject. The proposal was considered as per the EIA Notification - 2006, by the State Level Expert Appraisal Committee-III, Maharashtra in its 93rd meeting and recommend the project for prior environmental clearance to SEIAA. Information submitted by you has been considered by State Level Environment Impact Assessment Authority in its 177th meetings.

2. It is noted that the proposal is considered by SEAC-III under screening category 8(a), B2 as per EIA Notification 2006.

**Brief Information of the project submitted by you is as below :-**

1.Name of Project	Residential Project
2.Type of institution	Private
3.Name of Project Proponent	Prakruti Constructions Pvt. Ltd.
4.Name of Consultant	Sneha Hi-Tech Products
5.Type of project	Residential and Commercial project
6.New project/expansion in existing project/modernization/diversification in existing project	Expansion in existing
7.If expansion/diversification, whether environmental clearance has been obtained for existing project	No
8.Location of the project	F.P.no. 105, S. no. 343/2, Tadiwala Road
9.Taluka	Haveli
10.Village	Sangamwadi
Correspondence Name:	Prakruti Constructions Pvt. Ltd.
Room Number:	-
Floor:	1st floor
Building Name:	Kumar Capital
Road/Street Name:	2413, East Street
Locality:	Camp
City:	Pune
11.Whether in Corporation / Municipal / other area	Pune Municipal Corporation
12.IOD/IOA/Concession/Plan Approval Number	Received IOD/IOA/Concession/Plan Approval Number: Sanctioned layout no. CC/4056/18 D.P.O/ Zone no. 4 dated 27/03/2019 Approved Built-up Area: 25389.07
13.Note on the initiated work (If applicable)	Four Buildings and a club house having built up area : 18630 Sqm have been completed based on plans sanctioned in 2002 & 2005.
14.LOI / NOC / IOD from MHADA/ Other approvals (If applicable)	NA
15.Total Plot Area (sq. m.)	12943.86 sq. m.
16.Deductions	0
17.Net Plot area	12943.86 sq. m.

**SEIAA Meeting No: 177 Meeting Date: October 3, 2019 ( SEIAA-STATEMENT-0000003618 )**  
**SEIAA-MINUTES-0000002613**  
**SEIAA-EC-0000002051**

Page 1 of 12

  
**Shri. Anil Diggikar (Member Secretary SEIAA)**

18 (a).Proposed Built-up Area (FSI & Non-FSI)	FSI area (sq. m.): 16540.30 sq. m.
	Non FSI area (sq. m.): 8848.77 sq. m.
	Total BUA area (sq. m.): 25389.07
18 (b).Approved Built up area as per DCR	Approved FSI area (sq. m.): 16540.30 sq. m.
	Approved Non FSI area (sq. m.): 8848.77 sq. m.
	Date of Approval: 27-03-2019
19.Total ground coverage (m2)	3238.65 sq. m.
20.Ground-coverage Percentage (%) (Note: Percentage of plot not open to sky)	25%
21.Estimated cost of the project	397603129



# Government of Maharashtra

## 22. Production Details

Serial Number	Product	Existing (MT/M)	Proposed (MT/M)	Total (MT/M)
1	Not applicable	Not applicable	Not applicable	Not applicable

## 23. Total Water Requirement

Dry season:	Source of water	PMC / Treated water from STP
	Fresh water (CMD):	182
	Recycled water - Flushing (CMD):	19 m3/day
	Recycled water - Gardening (CMD):	7 m3/day
	Swimming pool make up (Cum):	6 m3/day
	Total Water Requirement (CMD) :	208m3/day
	Fire fighting - Underground water tank(CMD):	300 m3
	Fire fighting - Overhead water tank(CMD):	120 m3
	Excess treated water	23 m3/day
Wet season:	Source of water	PMC / Treated water from STP
	Fresh water (CMD):	182
	Recycled water - Flushing (CMD):	19 m3/day
	Recycled water - Gardening (CMD):	0
	Swimming pool make up (Cum):	6 m3/day
	Total Water Requirement (CMD) :	201m3/day
	Fire fighting - Underground water tank(CMD):	300 m3
	Fire fighting - Overhead water tank(CMD):	120 m3
	Excess treated water	30 m3/day
Details of Swimming pool (If any)	Area- 247.86 sq.m.	

24.Details of Total water consumed									
Particulars	Consumption (CMD)			Loss (CMD)			Effluent (CMD)		
Water Requirement	Existing	Proposed	Total	Existing	Proposed	Total	Existing	Proposed	Total
Domestic	Not applicable	Not applicable	Not applicable	Not applicable	Not applicable	Not applicable	Not applicable	Not applicable	Not applicable
25.Rain Water Harvesting (RWH)	Level of the Ground water table:		Post Monsoon 4 to 6 m BGL & pre monsoon 12 to 15 m BGL						
	Size and no of RWH tank(s) and Quantity:		NA						
	Location of the RWH tank(s):		NA						
	Quantity of recharge pits:		4 Nos						
	Size of recharge pits :		2 m x 1 m x 2 m						
	Budgetary allocation (Capital cost) :		5 Lakh						
	Budgetary allocation (O & M cost) :		0.75 Lakh/year						
	Details of UGT tanks if any :		Drinking 58.00 CuM Domestic - 207.00 CuM Fire- 300.00 CuM						
26.Storm water drainage	Natural water drainage pattern:		Towards North-West						
	Quantity of storm water:		0.22 m3/sec						
	Size of SWD:		450 mm x 300 mm						
27.Sewage and Waste water	Sewage generation in KLD:		181 KLD						
	STP technology:		MBBR						
	Capacity of STP (CMD):		1 no. with capacity of 55 KLD						
	Location & area of the STP:		Location is as per master layout and area is 40 sq. m.						
	Budgetary allocation (Capital cost):		22.40 Lakh						
	Budgetary allocation (O & M cost):		7.80 Lakh/year						

## 28.Solid waste Management

<b>Waste generation in the Pre Construction and Construction phase:</b>	<b>Waste generation:</b>	Empty cement bags, steel, sand, packaging material, Aggregates
	<b>Disposal of the construction waste debris:</b>	Excavated earth material will be used for filling of plinth area
<b>Waste generation in the operation Phase:</b>	<b>Dry waste:</b>	317kg/day
	<b>Wet waste:</b>	446kg/day
	<b>Hazardous waste:</b>	NA
	<b>Biomedical waste (If applicable):</b>	NA
	<b>STP Sludge (Dry sludge):</b>	8 kg/day
	<b>Others if any:</b>	E- waste 939kg/year
<b>Mode of Disposal of waste:</b>	<b>Dry waste:</b>	Handed over to agency for further handling & disposal
	<b>Wet waste:</b>	Through Mechanical Composter (Smart OWC)
	<b>Hazardous waste:</b>	NA
	<b>Biomedical waste (If applicable):</b>	NA
	<b>STP Sludge (Dry sludge):</b>	To be used as manure for gardening purpose or will be disposed off as per CPHEEO manual on sewerage
	<b>Others if any:</b>	E Waste-Handed over to authorized recycler for further handling & disposal purpose
<b>Area requirement:</b>	<b>Location(s):</b>	Locations are as per master layout
	<b>Area for the storage of waste &amp; other material:</b>	12 sq. m.
	<b>Area for machinery:</b>	36 sq. m.
<b>Budgetary allocation (Capital cost and O&amp;M cost):</b>	<b>Capital cost:</b>	14.75 lakh
	<b>O &amp; M cost:</b>	2.80 Lakh/year

Government of  
Maharashtra



**29.Effluent Charecterestics**

Serial Number	Parameters	Unit	Inlet Effluent Charecterestics	Outlet Effluent Charecterestics	Effluent discharge standards (MPCB)
1	Not applicable	Not applicable	Not applicable	Not applicable	Not applicable
Amount of effluent generation (CMD):		Not applicable			
Capacity of the ETP:		Not applicable			
Amount of treated effluent recycled :		Not applicable			
Amount of water send to the CETP:		Not applicable			
Membership of CETP (if require):		Not applicable			
Note on ETP technology to be used		Not applicable			
Disposal of the ETP sludge		Not applicable			



# Government of Maharashtra

30.Hazardous Waste Details							
Serial Number	Description	Cat	UOM	Existing	Proposed	Total	Method of Disposal
1	Not applicable	Not applicable	Not applicable	Not applicable	Not applicable	Not applicable	Not applicable

31.Stacks emission Details						
Serial Number	Section & units	Fuel Used with Quantity	Stack No.	Height from ground level (m)	Internal diameter (m)	Temp. of Exhaust Gases
1	Not applicable	Not applicable	Not applicable	Not applicable	Not applicable	Not applicable

32.Details of Fuel to be used				
Serial Number	Type of Fuel	Existing	Proposed	Total
1	Not applicable	Not applicable	Not applicable	Not applicable
Source of Fuel		Not applicable		
Mode of Transportation of fuel to site		Not applicable		

33.Energy		
Power requirement:	Source of power supply :	MSEDCL
	During Construction Phase: (Demand Load)	116 kVA
	DG set as Power back-up during construction phase	125 kVA
	During Operation phase (Connected load):	1565 KW
	During Operation phase (Demand load):	790 kVA
	Transformer:	630 kva X 2 nos.
	DG set as Power back-up during operation phase:	1 no. x 140 kVA & 1 no. x 125 kVA
	Fuel used:	HSD
	Details of high tension line passing through the plot if any:	NA

34.Energy saving by non-conventional method:	
LED fixtures Low Loss Transformer Solar Water Heater Solar PV cell Automatic Timer logic controller VFD for Lift	

36.Detail calculations & % of saving:		
Serial Number	Energy Conservation Measures	Saving %
1	Total Energy Saving in Project by Energy saving measures	9.98%

37.Details of pollution control Systems		
Source	Existing pollution control system	Proposed to be installed
Not applicable	Not applicable	Not applicable

Budgetary allocation (Capital cost and O&M cost):		Capital cost:	52.36 Lkah				
		O & M cost:	1.30 Lakh/year				
38.Environmental Management plan Budgetary Allocation							
a) Construction phase (with Break-up):							
Serial Number	Attributes	Parameter	Total Cost per annum (Rs. In Lacs)				
1	Air Environment	Water For Dust Suppression , Air & Noise Monitoring	2.00				
2	Water	Tanker Water For Construction, Water Monitoring	2.50				
3	Land	Site Sanitation	1.50				
4	Socio-Economic	Control, First Aid Facilities, Health Check Up, Personal Protective Equipment	4.00				
5	Environmental Monitoring	Air, Water, Noise & DG Stack	2.00				
b) Operation Phase (with Break-up):							
Serial Number	Component	Description	Capital cost Rs. In Lacs	Operational and Maintenance cost (Rs. in Lacs/yr)			
1	STP	STP cost considered	22.40	7.80			
2	Rain Water Harvesting	No. of pits	5	0.75			
3	Solid Waste Management	To assure proper disposal of Dry and Wet Waste, 1 no OWC will be provided	14.75	2.80			
4	Landscape	Plantation & gardening	10	1.80			
5	Energy	With all said energy saving measures like solar panels and solar water heaters	52.36	1.30			
6	Environmental Monitoring	"Ambient Air quality, Noise level, Exhaust from DG Set, drinking water,sewage from STP as per EP act,	-	2.50			
39.Storage of chemicals (inflammable/explosive/hazardous/toxic substances)							
Description	Status	Location	Storage Capacity in MT	Maximum Quantity of Storage at any point of time in MT	Consumption / Month in MT	Source of Supply	Means of transportation
Not applicable	Not applicable	Not applicable	Not applicable	Not applicable	Not applicable	Not applicable	Not applicable
40.Any Other Information							
No Information Available							

	<b>CRZ/ RRZ clearance obtain, if any:</b>	NA
	<b>Distance from Protected Areas / Critically Polluted areas / Eco-sensitive areas/ inter-State boundaries</b>	NA
	<b>Category as per schedule of EIA Notification sheet</b>	8(a), B2
	<b>Court cases pending if any</b>	No
	<b>Other Relevant Informations</b>	NA
	<b>Have you previously submitted Application online on MOEF Website.</b>	No
	<b>Date of online submission</b>	-

**3. The proposal has been considered by SEIAA in its 177th meeting & decided to accord environmental clearance to the said project under the provisions of Environment Impact Assessment Notification, 2006 subject to implementation of the following terms and conditions:**

**Specific Conditions:**

<b>I</b>	PP to submit CER plan to Municipal Commissioner/District Collector and submit the acknowledgement to Member Secretary, SEIAA.
<b>II</b>	PP Shall comply with Standard EC conditions mentioned in the Office Memorandum issued by MoEF & CC vide F.No.22-34/2018-IA.III dt.04.01.2019.
<b>III</b>	SEIAA decided to grant EC for -FSI: 16540.30 m2, Non-FSI: 8848.77 m2 and Total BUA: 25389.07 m2 ( Plan Approval no-CC/4056/18 DPO/Zone no.4 Date- 27.03.2019)

**General Conditions:**

<b>I</b>	E-waste shall be disposed through Authorized vendor as per E-waste (Management and Handling) Rules, 2016.
<b>II</b>	The Occupancy Certificate shall be issued by the Local Planning Authority to the project only after ensuring sustained availability of drinking water, connectivity of sewer line to the project site and proper disposal of treated water as per environmental norms.
<b>III</b>	This environmental clearance is issued subject to obtaining NOC from Forestry & Wild life angle including clearance from the standing committee of the National Board for Wild life as if applicable & this environment clearance does not necessarily implies that Forestry & Wild life clearance granted to the project which will be considered separately on merit.
<b>IV</b>	PP has to abide by the conditions stipulated by SEAC& SEIAA.
<b>V</b>	The height, Construction built up area of proposed construction shall be in accordance with the existing FSI/FAR norms of the urban local body & it should ensure the same along with survey number before approving layout plan & before according commencement certificate to proposed work. Plan approving authority should also ensure the zoning permissibility for the proposed project as per the approved development plan of the area.
<b>VI</b>	If applicable Consent for Establishment" shall be obtained from Maharashtra Pollution Control Board under Air and Water Act and a copy shall be submitted to the Environment department before start of any construction work at the site.
<b>VII</b>	All required sanitary and hygienic measures should be in place before starting construction activities and to be maintained throughout the construction phase.
<b>VIII</b>	Adequate drinking water and sanitary facilities should be provided for construction workers at the site. Provision should be made for mobile toilets. The safe disposal of wastewater and solid wastes generated during the construction phase should be ensured.
<b>IX</b>	The solid waste generated should be properly collected and segregated. dry/inert solid waste should be disposed off to the approved sites for land filling after recovering recyclable material.
<b>X</b>	Disposal of muck during construction phase should not create any adverse effect on the neighboring communities and be disposed taking the necessary precautions for general safety and health aspects of people, only in approved sites with the approval of competent authority.
<b>XI</b>	Arrangement shall be made that waste water and storm water do not get mixed.
<b>XII</b>	All the topsoil excavated during construction activities should be stored for use in horticulture / landscape development within the project site.
<b>XIII</b>	Additional soil for leveling of the proposed site shall be generated within the sites (to the extent possible) so that natural drainage system of the area is protected and improved.
<b>XIV</b>	Green Belt Development shall be carried out considering CPCB guidelines including selection of plant species and in consultation with the local DFO/ Agriculture Dept.

XV	Soil and ground water samples will be tested to ascertain that there is no threat to ground water quality by leaching of heavy metals and other toxic contaminants.
XVI	Construction spoils, including bituminous material and other hazardous materials must not be allowed to contaminate watercourses and the dumpsites for such material must be secured so that they should not leach into the ground water.
XVII	Any hazardous waste generated during construction phase should be disposed off as per applicable rules and norms with necessary approvals of the Maharashtra Pollution Control Board.
XVIII	The diesel generator sets to be used during construction phase should be low sulphur diesel type and should conform to Environments (Protection) Rules prescribed for air and noise emission standards.
XIX	The diesel required for operating DG sets shall be stored in underground tanks and if required, clearance from concern authority shall be taken.
XX	Vehicles hired for bringing construction material to the site should be in good condition and should have a pollution check certificate and should conform to applicable air and noise emission standards and should be operated only during non-peak hours.
XXI	Ambient noise levels should conform to residential standards both during day and night. Incremental pollution loads on the ambient air and noise quality should be closely monitored during construction phase. Adequate measures should be made to reduce ambient air and noise level during construction phase, so as to conform to the stipulated standards by CPCB/MPCB.
XXII	Fly ash should be used as building material in the construction as per the provisions of Fly Ash Notification of September 1999 and amended as on 27th August, 2003. (The above condition is applicable only if the project site is located within the 100Km of Thermal Power Stations).
XXIII	Ready mixed concrete must be used in building construction.
XXIV	Storm water control and its re-use as per CGWB and BIS standards for various applications.
XXV	Water demand during construction should be reduced by use of pre-mixed concrete, curing agents and other best practices referred.
XXVI	The ground water level and its quality should be monitored regularly in consultation with Ground Water Authority.
XXVII	The installation of the Sewage Treatment Plant (STP) should be certified by an independent expert and a report in this regard should be submitted to the MPCB and Environment department before the project is commissioned for operation. Discharge of this unused treated effluent, if any should be discharge in the sewer line. Treated effluent emanating from STP shall be recycled/refused to the maximum extent possible. Discharge of this unused treated effluent, if any should be discharge in the sewer line. Treatment of 100% gray water by decentralized treatment should be done. Necessary measures should be made to mitigate the odour problem from STP.
XXVIII	Permission to draw ground water and construction of basement if any shall be obtained from the competent Authority prior to construction/operation of the project.
XXIX	Separation of gray and black water should be done by the use of dual plumbing line for separation of gray and black water.
XXX	Fixtures for showers, toilet flushing and drinking should be of low flow either by use of aerators or pressure reducing devices or sensor based control.
XXXI	Use of glass may be reduced up to 40% to reduce the electricity consumption and load on air conditioning. If necessary, use high quality double glass with special reflective coating in windows.
XXXII	Roof should meet prescriptive requirement as per Energy Conservation Building Code by using appropriate thermal insulation material to fulfill requirement.
XXXIII	Energy conservation measures like installation of CFLs /TFLs for the lighting the areas outside the building should be integral part of the project design and should be in place before project commissioning. Use CFLs and TFLs should be properly collected and disposed off/sent for recycling as per the prevailing guidelines/rules of the regulatory authority to avoid mercury contamination. Use of solar panels may be done to the extent possible like installing solar street lights, common solar water heaters system. Project proponent should install, after checking feasibility, solar plus hybrid non-conventional energy source as source of energy.
XXXIV	Diesel power generating sets proposed as source of backup power for elevators and common area illumination during operation phase should be of enclosed type and conform to rules made under the Environment (Protection) Act, 1986. The height of stack of DG sets should be equal to the height needed for the combined capacity of all proposed DG sets. Use low sulphur diesel. The location of the DG sets may be decided with in consultation with Maharashtra Pollution Control Board.
XXXV	Noise should be controlled to ensure that it does not exceed the prescribed standards. During nighttime the noise levels measured at the boundary of the building shall be restricted to the permissible levels to comply with the prevalent regulations.
XXXVI	Traffic congestion near the entry and exit points from the roads adjoining the proposed project site must be avoided. Parking should be fully internalized and no public space should be utilized.
XXXVII	Opaque wall should meet prescriptive requirement as per Energy Conservation Building Code, which is proposed to be mandatory for all air-conditioned spaces while it is aspiration for non-air-conditioned spaces by use of appropriate thermal insulation material to fulfill requirement.
XXXVIII	The building should have adequate distance between them to allow movement of fresh air and passage of natural light, air and ventilation.
XXXIX	Regular supervision of the above and other measures for monitoring should be in place all through the construction phase, so as to avoid disturbance to the surroundings.
XL	Under the provisions of Environment (Protection) Act, 1986, legal action shall be initiated against the project proponent if it was found that construction of the project has been started without obtaining environmental clearance.



<b>XL I</b>	Six monthly monitoring reports should be submitted to the Regional office MoEF, Bhopal with copy to this department and MPCB.
<b>XLII</b>	Project proponent shall ensure completion of STP, MSW disposal facility, green belt development prior to occupation of the buildings. As agreed during the SEIAA meeting, PP to explore possibility of utilizing excess treated water in the adjacent area for gardening before discharging it into sewer line No physical occupation or allotment will be given unless all above said environmental infrastructure is installed and made functional including water requirement in Para 2. Prior certification from appropriate authority shall be obtained.
<b>XLIII</b>	Wet garbage should be treated by Organic Waste Converter and treated waste (manure) should be utilized in the existing premises for gardening. And, no wet garbage will be disposed outside the premises. Local authority should ensure this.
<b>XLIV</b>	Local body should ensure that no occupation certification is issued prior to operation of STP/MSW site etc. with due permission of MPCB.
<b>XLV</b>	A complete set of all the documents submitted to Department should be forwarded to the Local authority and MPCB.
<b>XLVI</b>	In the case of any change(s) in the scope of the project, the project would require a fresh appraisal by this Department.
<b>XLVII</b>	A separate environment management cell with qualified staff shall be set up for implementation of the stipulated environmental safeguards.
<b>XLVIII</b>	Separate funds shall be allocated for implementation of environmental protection measures/EMP along with item-wise breaks-up. These cost shall be included as part of the project cost. The funds earmarked for the environment protection measures shall not be diverted for other purposes and year-wise expenditure should reported to the MPCB & this department.
<b>XLIX</b>	The project management shall advertise at least in two local newspapers widely circulated in the region around the project, one of which shall be in the Marathi language of the local concerned within seven days of issue of this letter, informing that the project has been accorded environmental clearance and copies of clearance letter are available with the Maharashtra Pollution Control Board and may also be seen at Website at <a href="http://ec.maharashtra.gov.in">http://ec.maharashtra.gov.in</a> .
<b>L</b>	Project management should submit half yearly compliance reports in respect of the stipulated prior environment clearance terms and conditions in hard & soft copies to the MPCB & this department, on 1st June & 1st December of each calendar year.
<b>LI</b>	A copy of the clearance letter shall be sent by proponent to the concerned Municipal Corporation and the local NGO, if any, from whom suggestions/representations, if any, were received while processing the proposal. The clearance letter shall also be put on the website of the Company by the proponent.
<b>LII</b>	The proponent shall upload the status of compliance of the stipulated EC conditions, including results of monitored data on their website and shall update the same periodically. It shall simultaneously be sent to the Regional Office of MoEF, the respective Zonal Office of CPCB and the SPCB. The criteria pollutant levels namely; SPM, RSPM, SO <sub>2</sub> , NO <sub>x</sub> (ambient levels as well as stack emissions) or critical sector parameters, indicated for the project shall be monitored and displayed at a convenient location near the main gate of the company in the public domain.
<b>LIII</b>	The project proponent shall also submit six monthly reports on the status of compliance of the stipulated EC conditions including results of monitored data (both in hard copies as well as by e-mail) to the respective Regional Office of MoEF, the respective Zonal Office of CPCB and the SPCB.
<b>LIV</b>	The environmental statement for each financial year ending 31st March in Form-V as is mandated to be submitted by the project proponent to the concerned State Pollution Control Board as prescribed under the Environment (Protection) Rules, 1986, as amended subsequently, shall also be put on the website of the company along with the status of compliance of EC conditions and shall also be sent to the respective Regional Offices of MoEF by e-mail.

# Government of Maharashtra

4. The environmental clearance is being issued without prejudice to the action initiated under EP Act or any court case pending in the court of law and it does not mean that project proponent has not violated any environmental laws in the past and whatever decision under EP Act or of the Hon'ble court will be binding on the project proponent. Hence this clearance does not give immunity to the project proponent in the case filed against him, if any or action initiated under EP Act.

5. In case of submission of false document and non-compliance of stipulated conditions, Authority/ Environment Department will revoke or suspend the Environment clearance without any intimation and initiate appropriate legal action under Environmental Protection Act, 1986.

6. The Environment department reserves the right to add any stringent condition or to revoke the clearance if conditions stipulated are not implemented to the satisfaction of the department or for that matter, for any other administrative reason.

7. Validity of Environment Clearance: The environmental clearance accorded shall be valid as per EIA Notification, 2006, and amendments by MoEF&CC Notification dated 29th April, 2015.

8. In case of any deviation or alteration in the project proposed from those submitted to this department for clearance, a fresh reference should be made to the department to assess the adequacy of the condition(s) imposed and to incorporate additional environmental protection measures required, if any.

9. The above stipulations would be enforced among others under the Water (Prevention and Control of Pollution) Act, 1974, the Air (Prevention and Control of Pollution) Act, 1981, the Environment (Protection) Act, 1986 and rules there under, Hazardous Wastes (Management and Handling) Rules, 1989 and its amendments, the public Liability Insurance Act, 1991 and its amendments.

10. Any appeal against this Environment clearance shall lie with the National Green Tribunal (Western Zone Bench, Pune), New Administrative Building, 1st Floor, D- Wing, Opposite Council Hall, Pune, if preferred, within 30 days as prescribed under Section 16 of the National Green Tribunal Act, 2010.

  
Shri. Anil Diggikar (Member Secretary SEIAA)

**Copy to:**

1. SHRI JOHNY JOSEPH, CHAIRMAN-SEIAA
2. SHRI UMAKANT DANGAT, CHAIRMAN-SEAC-I
3. SHRI M.M.ADTANI, CHAIRMAN-SEAC-II
4. SHRI ANIL .D. KALE, CHAIRMAN SEAC-III
5. SECRETARY MOEF & CC
6. IA- DIVISION MOEF & CC
7. MEMBER SECRETARY MAHARASHTRA POLLUTION CONTROL BOARD MUMBAI
8. REGIONAL OFFICE MOEF & CC NAGPUR
9. MUNICIPAL COMMISSIONER PUNE
10. MUNICIPAL COMMISSIONER SATARA
11. REGIONAL OFFICE MPCB PUNE
12. REGIONAL OFFICE MIDC PUNE
13. MAHARASHTRA STATE ELECTRICITY DISTRIBUTION CO. LTD
14. COLLECTOR OFFICE PUNE
15. COLLECTOR OFFICE SATARA
16. COLLECTOR OFFICE SOLAPUR





Date-27/07/2019

To,  
M/S. Prakruti Constructions Pvt. Ltd.,  
Office At Kumar Capital, 2413, 1<sup>st</sup> floor, East Street, Camp, Pune.

Sub: - Facilitating Solid Waste Management At Your Commercial/Residential Project "**Residential Project**" Situated At F. P. No. 105, S. No. 343/2, Tadiwala Road, Sangamwadi, Pune.

Dear Sir,

With reference to above subject we intend to facilitate the management of solid waste at your proposed project.

SWaCH Seva Sahakari Sanstha Maryadit, Pune (SWaCH) is India's first wholly-owned cooperative of self-employed waste pickers or waste collectors and other urban poor. It is an autonomous enterprise that ensures provision of front-end waste management services to the citizens of Pune through self-employed informal waste-pickers.

We will facilitate the collection of segregated dry waste (recyclables and non-recyclables: 317 Kg/Day, E-Waste- 939 Kg/Year) from your registered project "**Residential Project**" Situated At F. P. No. 105, S. No. 343/2, Tadiwala Road, Sangamwadi, Pune., through waste-picker members of SWaCH after completion of project.

Further, you have also confirmed that you have acquired the necessary equipment and infrastructure (OWC: 446 Kg/Day) for management of wet waste at source. If necessary, we can assist in facilitating in-situ wet waste processing using existing infrastructure and equipment through waste-pickers within the premises of your registered project through such affiliates and subject to such terms and conditions as may be applicable. We ensure collection of E-waste from the site at a cost mutually decided. All commercial terms must be negotiated with waste-pickers prior to commencement of work.

Assuring you the best of our services.

Thanking You,

For SWaCH Pune Seva Sahakari Sanstha Ltd



Authorized Signatory

27/07/2019

स्वच्छ पुणे सेवा सहकारी संस्था मर्यादित ही कचरावेचकांची स्वायत्त सहकारी संस्था असून दारोदार कचरा गोळा करण्याची सेवा पुरवण्याकरिता पुणे महानगरपालिकेने अधिकृत केलेली संस्था आहे.

कोथरुड कचरा डेपो, पौड रस्ता, कोथरुड, पुणे ४११ ०३८

दु.: ०२० ६५०००८१७ स्वच्छ हेल्पलाईन : ९७६५९९५०० ई-मेल : swachcoop@gmail.com

New address -  
3rd Floor, Old Tilak Road Ward Office,  
Above SBI (Tilak Road Branch), Pune 411042

(Reg No. PNA (1) GNL/O/1321/07-08)

वेबसाईट : www.swachcoop.com



STAMP OF APPROVAL

1/1

## F.S.I. STATEMENT (EXISTING)

WINGS	NO OF FLOORS	NO OF TENE.	BUILDING HEIGHT	GR. COVER.	COMM. F.S.I.	RESI. F.S.I.	TOTAL F.S.I.	BALCONY	TOTAL FSI CONSUMED	PASSAGE	STAIRCASE	LIFT+LMR	TERRACE
								PERMI. PROP. EXCESS					
A1	P+8	48	27.21	440.34	231.85	2813.28	3045.13	423.84	12307.61	218.72	129.52	24.66	354.72
A2	P+8	48	27.21	440.34	235.49	2813.28	3048.77	423.84	12307.61	218.72	129.52	24.66	354.72
A3	P+8	48	27.21	440.34	235.49	2813.28	3048.77	423.84	12307.61	218.72	129.52	24.66	354.72
A6	P+9	54	28.25	440.34	-	3164.94	3164.94	476.82	12307.61	246.06	145.71	24.66	409.32
TOTAL	-	198	-	1761.36	702.83	11604.78	12307.61	1846.14	1748.34	902.22	534.27	98.64	1473.48

## F.S.I. STATEMENT (PROPOSED)

WINGS	NO OF FLOORS	NO OF TENE.	BUILDING HEIGHT	GR. COVER.	F.S.I.	TOTAL F.S.I.	BALCONY	TOTAL FSI CONSUMED	STAIRCASE	LIFT+LMR	TERRACE
							PERMI. PROP. EXCESS				
A4	P+7	28	24.00	258.11	1806.77	1806.77	423.69	423.69	105.70	30.45	
A5	P+7	56	24.00	346.56	2425.92	2425.92	341.74	423.69	183.54	43.67	
TOTAL	-	84	-	604.67	4232.69	4232.69	634.90	588.21	289.24	74.12	

## F.S.I. STATEMENT (EXISTING+PROPOSED)

	NO OF TENE.	GR. COVER.	F.S.I.	PROP. BALC.	PASSAGE	STAIRCASE	LIFT+LMR	TERRACE
EXISTING	198	1761.36	12307.61	1748.34	902.22	534.27	98.64	1473.48
PROPOSED	84	604.67	4232.69	588.21	-	289.24	74.12	-
TOTAL	282	2366.03	16540.30	2336.55	902.22	823.51	172.76	1473.48

## F.S.I. &amp; NON F.S.I. STATEMENT

WING	EXISTING COMMERCIAL F.S.I.	EXISTING RESIDENTIAL F.S.I.	PROPOSED RESIDENTIAL F.S.I.	TOTAL F.S.I.	BALCONY PROP.	PASSAGE	STAIRCASE	LIFT+LMR	TERRACE
A1	231.85	2813.28	-	3045.13	423.84	218.72	129.52	24.66	354.72
A2	235.49	2813.28	-	3048.77	423.84	218.72	129.52	24.66	354.72
A3	235.49	2813.28	-	3048.77	423.84	218.72	129.52	24.66	354.72
A4	-	-	1806.77	1806.77	246.47	-	105.70	30.45	-
A5	-	-	2425.92	2425.92	341.74	-	183.54	43.67	-
A6	-	3164.94	-	3164.94	476.82	246.06	145.71	24.66	409.32
TOTAL	702.83	11604.78	4232.69	16540.30	2336.55	902.22	823.51	172.76	1473.48

TOTAL F.S.I.	16540.30
FREE OF FSI AREA	5708.52
PARKING AREA	2792.06
OHWT	97.53
UG TANK	102.56
TRANSFORMER AREA	25.00
CLUB HOUSE	123.10
GRAND TOTAL	25389.07

## T.D.R. AREA STATEMENT

T.D.R. ORIGINATED FROM	= PARVATI S.NO. 121A, 122A/1 PLOT NO. 537
T.D.R. TO BE USED ON	= S.NO. 343/2 F.P. NO. 537 C.T.S. NO. TADIWALA ROAD SANGAMWADI PUNE.
T.D.R. AREA TO BE USED	= 800.00 SQ.M.
T.D.R. AREA (WHICH ZONE)	= 'B' ZONE
NO. OF TENE. DUE TO T.D.R.	= 23 NOS.
HEIGHT OF BUILDING	= 27.21 M
NO. OF FLOORS DUE TO T.D.R.	= WING A1/A2/A3 FLOOR 6th/7th/8th PART WING A6 WING A5 FLOOR 1st FLOOR (FULL)
WORK STAGE IN PROG.	= WORK IN PROGRESS
PREVIOUS SANCTION NO.	= C.C. NO. 2905 DATE- 10/04/2002

## WATER REQUIREMENT

WING	O.H.W.T	U.G.W.T
'A1'	34170.00	51255.00
'A2'	34170.00	51255.00
'A3'	34170.00	51255.00
'A4'	28900.00	28350.00
'A5'	47800.00	56700.00
'A6'	36450.00	54675.00
TOTAL	215660.00	293490.00

## TENEMENT STATEMENT :-

NET PLOT AREA	= 11649.48
DEDUCTIONS OF NON-RESI. AREA	= 702.83
AREA OF TENEMENTS	= 10946.65
TENE. PERMISSIBLE	= 250T/HA
	= 273.67
SAYS	= 274
TENE. PROPOSED	= 282

## PARKING STATEMENT

WING	TENE	CAR	SCOOTER	CYCLE
WING A1+A2+A3+A6				
COMM AREA FOR 100 SQ.M.	2	4	4	
PROP. COMM AREA 585 SQ.M.	12	24	24	
TENE. UPTO 40 SQ.M.	4	1	6	4
PROP TENE. BETWEEN 40-80 SQ.M.	66	17	102	68
TENE. BETWEEN 40-80 SQ.M.	2	1	2	2
PROP TENE. BETWEEN 40-80 SQ.M.	132	66	264	264
WING A4				
TENE. BETWEEN 40-80 SQ.M.	28	2	4	2
PROP TENE. BETWEEN 40-80 SQ.M.	28	56	28	
WING A5				
TENE. BETWEEN 0-40 SQ.M.	2	1	4	4
PROP TENE. BETWEEN 40-80 SQ.M.	56	28	112	112
TOTAL PARKING REQ.	151	558	496	
PARKING PROVIDED	151	558	500	
AREA REQ. PER PARKING	12.50	2.00	0.70	
TOTAL AREA REQ.	1888	1116	347	

विद्युत योजना कार्यालय  
मान्य लेआउट क्र. CC/4056/18  
डि.पी.ओ./ड्रांग क्र. 4 दिनांक 23/3/2019

कार्यकारी अधिकारी  
विकास योजना अधिकार निबंधन (क्र. 4)  
पुणे महानगरपालिका

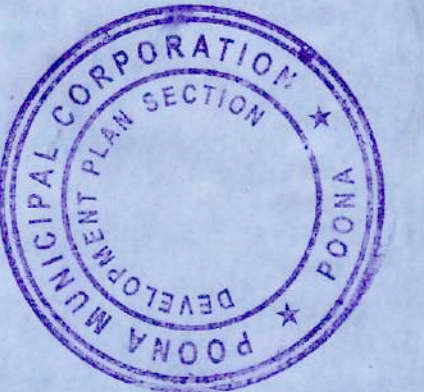

जमिन विप्लवन निधी \_\_\_\_\_ चौ. मी. क्षेत्रासाठी  
परमिट क्र. \_\_\_\_\_ दि. \_\_\_\_\_  
राजी धरले आहेत.

For the purpose of proper circulation road pattern and to have a continuity of the water & drainage system and other services for the development of adjacent lands the P.M.C. reserves the right to permit access and extension of the internal access and extension of the internal roads & services through this land under layout sub-division

PROPOSED SITE



## LOCATION PLAN

AREA STATEMENT	SQM
1. PLOT AREA AS PER P.R.C.	13942.69
AREA OF PLOT (AS PER 'B' FORM)	12943.86
2. DEDUCTIONS FOR	
(a) AREA UNDER D.P. ROAD	0.00
(b) ANY RESERVATIONS	0.00
(c) ENCROACHMENT	0.00
3. BALANCE AREA OF PLOT	12943.86
4. LESS AREA OF	
(a) OPEN SPACE (10% OF 3)	1294.38
(b) AREA UNDER INTERNAL ROAD	0.00
5. NET GROSS AREA OF PLOT AREA	12943.86
6. PERMISSIBLE BASIC FSI (12943.86X1.10)	14238.25
7. PERMISSIBLE SLUM T.D.R. (12943.86X40% X 200%)	1035.50
8. PERMISSIBLE AMENITY T.D.R. (40% ON 12943.86 - 7)	4142.04
9. PERMISSIBLE 0.30 PREMIUM FSI (0.30% ON 12943.86)	3883.16
10. TOTAL PERMISSIBLE F.S.I. (5+6)	23298.95
11. EXISTING F.S.I.	12307.61
12. PROPOSED F.S.I.	4232.69
13. EXISTING + PROPOSED F.S.I.	16540.30

## LEGEND

PLOT LINE SHOWN - BLACK  
PROPOSED WORK SHOWN - RED  
DRAINAGE LINE SHOWN - RED DOTTED  
WATER LINE SHOWN - BLACK DOTTED  
EXISTING TO BE RETAINED - HATCHED BLUE  
EXISTING TO BE DEMOLISHED - HATCHED YELLOW

## NORTH



## PROJECT

PROPOSED BUILDING ON F.P. NO.105, S.NO. 343/2 TADIWALA ROAD, SANGAMWADI, PUNE.

## OWNER'S NAME, SIGNATURE

Shri. Kewal Kumar Jain (P.A.H.)

SHRI. KEWAL KUMAR JAIN (P.A.H.)

## ARCHITECT :-

JAGADISH P. DESHPANDE  
ARCHITECT, TOWN PLANNER, INTERIOR DESIGNER  
A-1, SUCCESS CHAMBERS, 1232 APTE ROAD,  
DECCAN GYM KHANA, PUNE 411004.  
PH. NO. 25532182, 25531141,  
C.A.84/8318 FAX. NO. -020-25532325

DATE	DEALT BY	REVISED BY	CHECKED BY	SCALE
28/02/2019	NILESH		ASHOK SIR	1:500

z/kumarproperties/s.no.343/2sangamwadi/submissiondrawing/building20181220sd

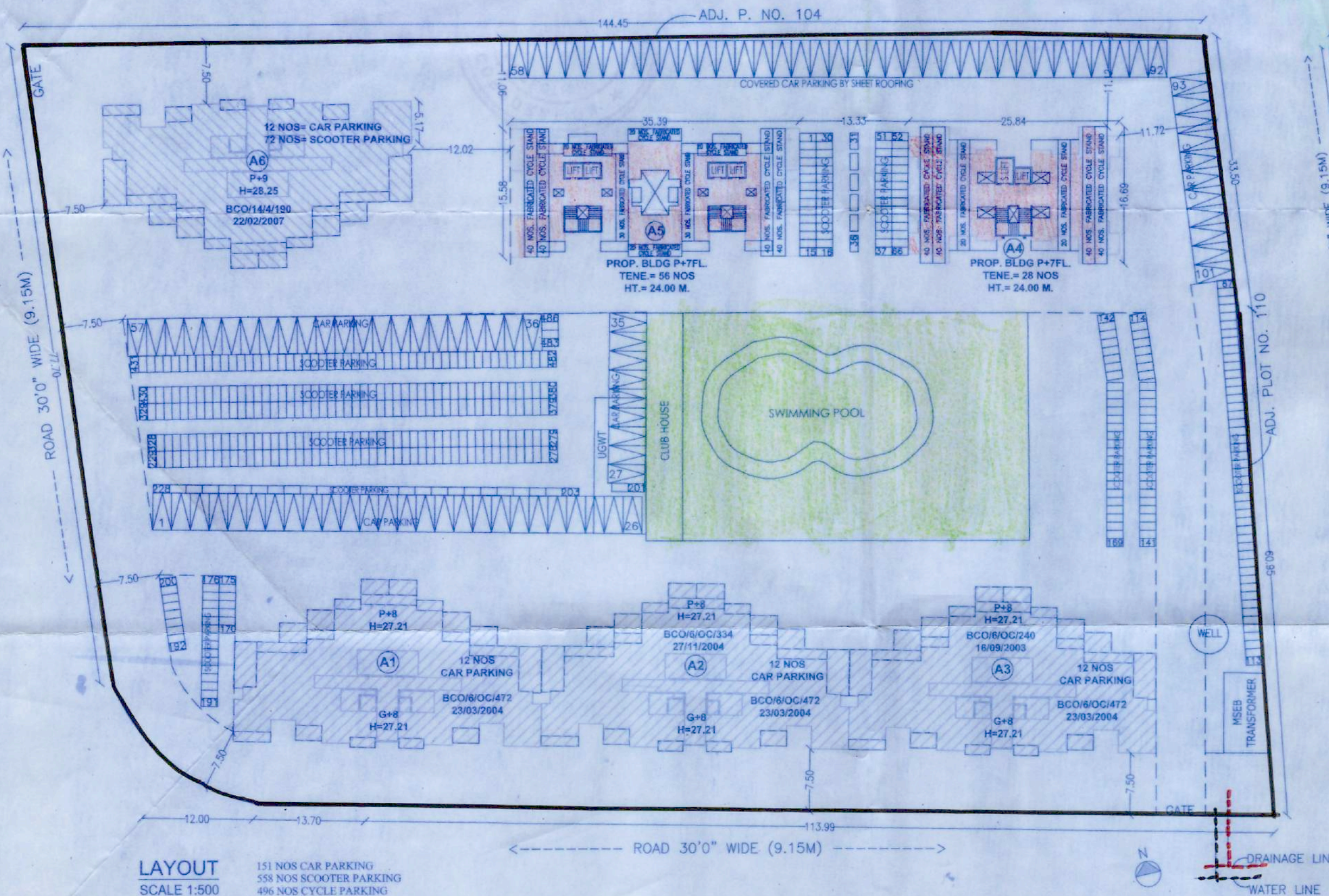

LAYOUT  
SCALE 1:500

151 NOS CAR PARKING  
558 NOS SCOOTER PARKING  
496 NOS CYCLE PARKING

PLOT AREA CALCULATION  
SCALE 1:1000

## OPEN SPACE AREA CALCULATION

OPEN SPACE AREA =  $23.73 + 23.91 \times 54.35 \times 0.50 = 1294.39$  SQ.M.

## PLOT AREA CALCULATION BY TRIANGULATION

1	$1/2 \times 46.50 \times 19.50$	=	453.375	SQ.M.
2	$1/2 \times 152.50 \times 26.00$	=	1982.50	SQ.M.
3	$1/2 \times 179.50 \times 49.50$	=	4442.625	SQ.M.
4	$1/2 \times 179.50 \times 71.00$	=	6372.25	SQ.M.
TOTAL AREA		=	13250.75	SQ.M.
LESS CHAMFER		=	57.17	SQ.M.
NET AREA OF PLOT		=	13193.58	SQ.M.

## AREA OF CHAMFER

= AREA OF TRIANGLE - AREA OF ARC  
 $= [1/2 \times 31.50 \times 11.50] - [4/3 \times 5.75 \times \sqrt{1/4 \times (31.5)^2 + 2/5 \times (5.75)^2}]$   
 $= [181.125] - [7.67 \times \sqrt{1/4 \times 992.25 + 2/5 \times 33.06}]$   
 $= [181.125] - [7.67 \times \sqrt{248.06 + 13.224}]$   
 $= [181.125] - [7.67 \times 16.16]$   
 $= 181.125 - 123.95 = 57.17$  SQ.M.

## PLOT AREA STATEMENT

F.P. NO. 105 S.NO. 343/2	AREA AS PER P.R.C.	AREA AS PER TRIANGULATION	AREA AS PER 'B' FORM	PLOT AREA CONSIDERED
	13942.69	13193.58	12943.86	12943.86





## MAHARASHTRA POLLUTION CONTROL BOARD

Phone : 24010437/24020781  
/24037124/24035273  
Fax : 24044532/24024068  
/24023516  
Email : jdwater @mpcb.gov.in  
Visit At : <http://mpcb.gov.in>



Kalpataru Point, 3rd & 4th floor,  
Sion- Matunga Scheme Road No. 8,  
Opp. Cine Planet Cinema, Near Sion Circle,  
Sion (E), Mumbai - 400022

Infrastructure /Orange/LSI

Consent order No: Format1.0/BO/JD (WPC)/UAN-084659/CE/CC- '2006000665' Date 15/06/2020

To,  
M/s. Prakruti Construction Pvt Ltd,  
F. No. 105, S.No. 343/2, Tadiwala Sangamwadi,  
Tal: Mulshi, Dist: Pune.

**Sub: Consent to Establish for Construction of Residential and commercial Project granted under Orange Category.**

**Ref:** Your Application vide UAN No. -0000084659 Dated: 12/12/2019.

For: Consent to Establish for Construction of residential and commercial project under Section 25 of the Water (Prevention & Control of Pollution) Act, 1974 & under Section 21 of the Air (Prevention & Control of Pollution) Act, 1981 and Authorization under Rule 5 of the Hazardous and Other Wastes (M & TM) Rules, 2016 is considered and the consent is hereby granted subject to the following terms and conditions and as detailed in the schedule I, II, III & IV annexed to this order:

1. The consent is granted for a period up to commissioning of the project or of 5 years whichever is earlier.
2. The proposed capital investment of the project is **Rs.10.58 Cr.**  
(As per CA certificate submitted by project proponent)

The Consent to Establish is valid for construction of residential and commercial Project named as **M/s. Prakruti Construction Pvt Ltd, F. No. 105, S.No. 343/2, Tadiwal Sangamwadi, Tal: Mulshi, Dist: Pune** for total plot area of **12,943.86 Sqm** and Proposed total construction built up area **25389.07 Sqm** as per EC dt.22/10.2019 including utilities and services as per Commencement Certificate issued by local body.

**3. Conditions under Water (P&CP), 1974 Act for discharge of effluent:**

Sr. No.	Description	Permitted quantity of discharge (CMD)	Standards to be achieved	Disposal
1.	Trade effluent	NIL	NA	NA
2.	Domestic effluent	51.0	As per Schedule -I	60% should be reused & recycled and remaining should be discharged in municipal sewer

**4. Conditions under Air (P&CP) Act, 1981 for air emissions:**

Sr. No.	Description of stack/ source	Capacity	Number Of Stack	Standards to be achieved
1.	DG Set	140 KVA	1	As Per Schedule -II
2.	DG Set	125 KVA	1	As Per Schedule -II

M/s. Prakruti Construction Pvt Ltd

UAN 084659

Page 1 of 6



5. Conditions under Solid Waste Management Rules, 2016:

Sr. no.	Type Of Waste	Quantity & UOM	Treatment	Disposal
1	Wet garbage	126.00 Kg/Day	Organics waste Converter with composting facility / Biogas digester with composting facility	Used as Manure
2	Dry garbage	84.00 Kg/Day	—	Segregate and Hand over to Local Body for recycling
3.	STP sludge	8.00 Kg/day	STP	Used as manure

6. Conditions under Hazardous and Other Wastes (M & TM) Rules, 2016 for treatment and disposal of hazardous waste; NIL.
7. The Board reserves the right to review, amend, suspend, revoke etc. this consent and the same should be binding on the industry.
8. This consent should not be construed as exemption from obtaining necessary NOC/permission from any other Government authorities.
9. Project Proponent shall comply the Construction and Demolition Waste Management Rules, 2016 which is notified by Ministry of Environment, Forest and Climate Change dtd.29/03/2016.
10. Project Proponent shall submit an affidavit in Board's prescribed format within 15 days regarding the compliance of conditions of EC/CRZ clearance and C to E.
11. Project Proponent shall install online monitoring systems for BOD, TSS and flow at the outlet of STP.
12. Project Proponent shall provide Organic waste digester with composting facility or Biogas digester with composting facility.
13. The applicant should comply with the conditions stipulated in Environmental Clearance Obtained from SEIAA, Environment Department, Government of Maharashtra, dtd. 22/10/2019 for total plot area **12943.86 Sqm** & total construction BUA area **25,389.07 Sqm**.

For and on behalf of the  
Maharashtra Pollution Control Board

Dr. Y. B. Sontakke  
Joint Director (WPC)

Received Consent fee of –

Sr. No.	Amount (Rs.)	Transaction . No.	Date	Drawn On
1	50,000/-	N53191012591006	19/12/2019	online

Copy to:

1. Regional Officer, MPCB, Pune and Sub-Regional Officer, Pune -I MPCB, – They are directed to ensure the compliance of the consent conditions.
2. Chief Accounts Officer, MPCB, Mumbai
3. CC desk- for record & website updating purposes.



Schedule-I

Terms & conditions for compliance of Water Pollution Control:

- 1) A) As per your application, you have proposed to install of Sewage Treatment Plants (STP) with the design capacity of **55.00 CMD**

B) The Applicant shall operate the effluent treatment plant (STP) to treat the sewage so as to achieve the following standards prescribed by the Board or under EP Act, 1986 and Rules made there under from time to time, whichever is stringent.

1.	pH	Between	6.5 to 9.0
2.	Total Suspended Solids	Not more than	20 mg/l.
3.	BOD 3 Days 27 degree C	Not more than	10 mg/l.
4.	Chemical oxygen Demand (COD)	Not to more than	50 mg/l.
5.	NH <sub>4</sub> N	Not more than	5 mg/l.
6.	N Total	Not more than	10 mg/l.
7.	Fecal Coliform MPN/100 MI	Less than	100.0

C) The treated effluent shall be 60% recycled for secondary purposes such as toilet flushing, air conditioning, firefighting, on land for gardening etc and remaining shall be discharged in to the municipal sewerage system.

D) Project proponent shall operate STP for five years from the date of obtaining occupation certificate.

The Board reserves its rights to review plans, Specifications or other data relating to plant setup for the treatment of waterworks for the purification thereof & the system for the disposal of sewage or trade effluent or in connection with the grant of any consent conditions. The Applicant should obtain prior consent of the Board to take steps to establish the unit or establish any treatment and disposal system or and extension or addition thereto

- 2) The industry should ensure replacement of pollution control system or its parts after expiry of its expected life as defined by manufacturer so as to ensure the compliance of standards and safety of the operation thereof.
- 3) The Applicant shall comply with the provisions of the Water (Prevention & Control of Pollution) Act, 1974 and as amended, by installing water meters and other provisions as contained in the said act.

Sr. no.	Purpose for water consumed	Water consumption quantity (CMD)
1.	Domestic purpose	57.00

- 4) The Applicant shall provide Specific Water Pollution control system as per the conditions of EP Act, 1986 and rule made there under from time to time.



Schedule-II

Terms & conditions for compliance of Air Pollution Control:

1. As per your application, you have proposed to install the Air pollution control (APC) system and also proposed to erect following stack (s) and to observe the following fuel pattern-

Sr. No.	Stack Attached To	APC System	Height in Mtrs.	Type Of Fuel	Quantity	UOM	S%	SO <sub>2</sub>
1.	DG Set (140 KVA)	Acoustic enclosure	2.37	HSD	40.0	Lit/Hr	--	--
2.	DG Set (125 KVA)	Acoustic enclosure	2.24	Diesel	100.0	Lit/Hr	--	--

\* Above roof of the building in which it is installed.

2. The applicant should operate and maintain above mentioned air pollution control system, so as to achieve the level of pollutants to the following standards.

Particulate matter	Not to exceed	150 mg/Nm <sup>3</sup>
--------------------	---------------	------------------------

3. The Applicant should obtain necessary prior permission for providing additional control equipment with necessary specifications and operation thereof or alteration or replacement alteration well before its life come to an end or erection of new pollution control equipment. The Board reserves its rights to vary all or any of the condition in the consent, if due to any technological improvement or otherwise such variation (including the change of any control equipment, other in whole or in part is necessary).



# Maharashtra Pollution Control Board

## 5ef2e33899513b24b0caebf6

### Schedule-III Details of Bank Guarantees

Sr. No.	Consent (C to E/O/R)	Amt of BG Imposed	Submission Period	Purpose of BG	Compliance Period	Validity Date
1	Consent to Establish	Rs. 10 lakh	15 Days	Towards Compliance of EC and consent conditions.	Up to Commissioning of the project	Up to Commissioning of the project

Maharashtra Pollution Control Board





Schedule-IV

General Conditions:

The following general conditions shall apply as per the type of the industry.

- 1) The applicant shall provide facility for collection of samples of sewage effluents, air emissions and hazardous waste to the Board staff at the terminal or designated points and shall pay to the Board for the services rendered in this behalf.
- 2) The firm shall strictly comply with the Water (P&CP) Act, 1974, Air (P&CP) Act, 1981 and environmental protection Act 1986 and Solid Waste Management Rules, 2016 and E-Waste (Management) Rules, 2016.
- 3) Drainage system shall be provided for collection of sewage effluents. Terminal manholes shall be provided at the end of the collection system with arrangement for measuring the flow. No sewage shall be admitted in the pipes/sewers downstream of the terminal manholes. No sewage shall find its way other than in designed and provided collection system.
- 4) Vehicles hired for bringing construction material to the site should be in good condition and should conform to applicable air and noise emission standards and should be operated only during non-peak hours.
- 5) Conditions for D.G. Set
  - a) Noise from the D.G. Set should be controlled by providing an acoustic enclosure or by treating the room acoustically.
  - b) Industry should provide acoustic enclosure for control of noise. The acoustic enclosure/ acoustic treatment of the room should be designed for minimum 25 dB (A) insertion loss or for meeting the ambient noise standards, whichever is on higher side. A suitable exhaust muffler with insertion loss of 25 dB (A) shall also be provided. The measurement of insertion loss will be done at different points at 0.5 meters from acoustic enclosure/room and then average.
  - c) The industry shall take adequate measures for control of noise levels from its own sources within the premises in respect of noise - to less than 55 dB(A) during day time and 45 dB(A) during the night time. Day time is reckoned between 6 a.m. to 10 p.m and night time is reckoned between 10 p.m to 6 a.m.
  - d) Industry should make efforts to bring down noise level due to DG set, outside industrial premises, within ambient noise requirements by proper siting and control measures.
  - e) Installation of DG Set must be strictly in compliance with recommendations of DG Set manufacturer.
  - f) A proper routine and preventive maintenance procedure for DG set should be set and followed in consultation with the DG manufacturer which would help to prevent noise levels of DG set from deteriorating with use.
  - g) D.G. Set shall be operated only in case of power failure.
  - h) The applicant should not cause any nuisance in the surrounding area due to operation of D.G. Set.
  - i) The applicant shall comply with the notification of MOEF dated 17.05.2002 regarding noise limit for generator sets run with diesel.
- 6) Solid Waste - The applicant shall provide onsite municipal solid waste processing system & shall comply with Solid Waste Management Rules, 2016 & E-Waste (M) Rules, 2016.
- 7) Affidavit undertaking in respect of no change in the status of consent conditions and compliance of the consent conditions the draft can be downloaded from the official web site of the MPCB.
- 8) The treated sewage shall be disinfected using suitable disinfection method
- 9) The firm shall submit to this office, the 30th day of September every year, the environment statement report for the financial year ending 31st march in the prescribed Form-V as per the provision of rule 14 of the Environmental (Protection) Second Amended rule 1992
- 10) The applicant shall Obtain Consent to Operate from Maharashtra Pollution Control Board before commissioning of the project.



# GREEN CIRCLE, INC.

Integrated HSEQR Consulting Engineers, Scientists & Trainers  
(Recognised By Ministry of Environment, Forest and Climate Change, New Delhi Under EPA 1986)  
(F. No. - 15018 / 06 / 2016 - CPW)  
(ISO 9001, 14001, 45001 & NABL / 17025 Certified Organisation)

Annexure - 5

Report No: GCI/V/Lab/EM-SP/22-23/May-00/0878

Date: 16/05/2022

## ANALYSIS REPORT

Client details		Sample Details	
Name	Residential Project by Prakruti Construction Pvt. Ltd.	Sample Code	GCI/V/22/E03/AA1
Address	F.P.NO. 105, S. NO. 343/2, TADIWALA ROAD PUNE	Location	NEAR SECURITY GATE
		Date of Sampling	09/05/2022
Sampling Done By	Mr.Kartik	Date of Sample Received	10/05/2022
Analysis Starts On	10/05/2022	Sampling Instrument	RDS, FPS
Analysis Completion On	14/05/2022	Sampling Method	IS 5182 : Part 5 : 1975

## AMBIENT AIR ANALYSIS RESULTS

Sr. No.	Parameters	Unit	Results	National Ambient Air Quality Standards (NAAQS) amended 2009	Reference Method
1	Particulate Matter (PM <sub>10</sub> )	µg/m <sup>3</sup>	63.5	100	IS 5182 : Part 23 : 2006
2	Particulate Matter (PM <sub>2.5</sub> )	µg/m <sup>3</sup>	55.5	60	NAAQS Guidelines
3	Sulphur dioxide (SO <sub>2</sub> )	µg/m <sup>3</sup>	22.5	80	IS 5182 : Part 2 : 2001
4	Oxides of Nitrogen (NO <sub>x</sub> )	µg/m <sup>3</sup>	20.5	80	IS 5182 : Part 6 : 2006
5	Carbon Monoxide CO	mg/m <sup>3</sup>	0.16	2.0	IS 5182 : Part 10 : 1999
6	Ozone as O <sub>3</sub>	µg/m <sup>3</sup>	18.5	100	NAAQS Guidelines
7	Lead as Pb	µg/m <sup>3</sup>	BDL (<0.1)	1.0	NAAQS Guidelines
8	Nickel as Ni	ng/m <sup>3</sup>	BDL (<1)	20	NAAQS Guidelines
9	Arsenic as As	ng/m <sup>3</sup>	BDL (<1)	6.0	NAAQS Guidelines
10	Ammonia as NH <sub>3</sub>	µg/m <sup>3</sup>	3.5	400	NAAQS Guidelines
11	Benzene, C <sub>6</sub> H <sub>6</sub>	µg/m <sup>3</sup>	BDL (<0.01)	5.0	IS 5182 (Part 11):2006
12	Benzo (a) Pyrene	ng/m <sup>3</sup>	BDL (<0.1)	1.0	Gas Chromatography



Authorized Signatory

- Analysis is subject to the condition in which the sample is received at our Laboratory.
- Reports cannot be used as evidence anywhere including judiciary purpose without our prior permission.
- Sample will be retained till one month from the date of sampling.

CORP. OFFICE & : Green Empire (Anupushpam), Above AXIS Bank, Nr. Yash Complex, Gotri Main Road, Vadodara - 390 021 (Gujarat), INDIA.  
R & D Tel.: +91 - 265 - 2371269 Cell: +91 93285 83835 Email: info@greencircleinc.com Website: www.greencircleinc.com

: ALSO AT :  
NEW DELHI GOA PUNE BENGALURU U.K. HYDERABAD KOLKATA DHARWAD MUMBAI PORT BLAIR  
: OVERSEAS :  
AUSTRALIA OMAN KUWAIT AFRICA VIETNAM BANGLADESH MYANMAR SRI LANKA UAE



# GREEN CIRCLE, INC.

Integrated HSEQR Consulting Engineers, Scientists & Trainers  
(Recognised By Ministry of Environment, Forest and Climate Change, New Delhi Under EPA 1986)  
(F. No. - 15018 / 06 / 2016 - CPW)  
(ISO 9001, 14001, 45001 & NABL / 17025 Certified Organisation)

Report No: GCI/V/Lab/EM-SP/22-23/May-00/0878

Date: 16/05/2022

## ANALYSIS REPORT

Client details		Sample Details	
Name	Residential Project by Prakruti Construction Pvt. Ltd.	Sample Code	GCI/V/22/E03/AA2
Address	F.P.NO. 105, S. NO. 343/2, Tadiwala Road, Pune	Location	SOUTHWEST CORNER OF SITE
		Date of Sampling	09/05/2022
Sampling Done By	Mr. Kartik	Date of Sample Received	10/05/2022
Analysis Starts On	10/05/2022	Sampling Instrument	RDS, FPS
Analysis Completion On	14/05/2022	Sampling Method	IS 5182 : Part 5 : 1975

## AMBIENT AIR ANALYSIS RESULTS

Sr. No.	Parameters	Unit	Results	National Ambient Air Quality Standards (NAAQS) amended 2009	Reference Method
1	Particulate Matter (PM <sub>10</sub> )	µg/m <sup>3</sup>	64.5	100	IS 5182 : Part 23 : 2006
2	Particulate Matter (PM <sub>2.5</sub> )	µg/m <sup>3</sup>	50.0	60	NAAQS Guidelines
3	Sulphur dioxide (SO <sub>2</sub> )	µg/m <sup>3</sup>	18.2	80	IS 5182 : Part 2 : 2001
4	Oxides of Nitrogen (NO <sub>x</sub> )	µg/m <sup>3</sup>	15.8	80	IS 5182 : Part 6 : 2006
5	Carbon Monoxide CO	mg/m <sup>3</sup>	0.13	2.0	IS 5182 : Part 10 : 1999
6	Ozone as O <sub>3</sub>	µg/m <sup>3</sup>	16.5	100	NAAQS Guidelines
7	Lead as Pb	µg/m <sup>3</sup>	BDL (<0.1)	1.0	NAAQS Guidelines
8	Nickel as Ni	ng/m <sup>3</sup>	BDL (<1)	20	NAAQS Guidelines
9	Arsenic as As	ng/m <sup>3</sup>	BDL (<1)	6.0	NAAQS Guidelines
10	Ammonia as NH <sub>3</sub>	µg/m <sup>3</sup>	3.4	400	NAAQS Guidelines
11	Benzene, C <sub>6</sub> H <sub>6</sub>	µg/m <sup>3</sup>	BDL (<0.01)	5.0	IS 5182 (Part 11):2006
12	Benzo (a) Pyrene	ng/m <sup>3</sup>	BDL (<0.1)	1.0	Gas Chromatography



Authorized Signatory

- Analysis is subject to the condition in which the sample is received at our Laboratory.
- Reports cannot be used as evidence anywhere including judiciary purpose without our prior permission.
- Sample will be retained till one month from the date of sampling.

CORP. OFFICE & : Green Empire (Anupushpam), Above AXIS Bank, Nr. Yash Complex, Gotri Main Road, Vadodara - 390 021 (Gujarat), INDIA.  
R & D Tel.: +91 - 265 - 2371269 Cell: +91 93285 83835 Email: info@greencircleinc.com Website: www.greencircleinc.com

NEW DELHI GOA PUNE BENGALURU U.K. : ALSO AT : HYDERABAD KOLKATA DHARWAD MUMBAI PORT BLAIR  
AUSTRALIA OMAN KUWAIT AFRICA : OVERSEAS : VIETNAM BANGLADESH MYANMAR SRI LANKA UAE



# GREEN CIRCLE, INC.

Integrated HSEQR Consulting Engineers, Scientists & Trainers  
(Recognised By Ministry of Environment, Forest and Climate Change, New Delhi Under EPA 1986)  
(F. No. - 15018 / 06 / 2016 - CPW)  
(ISO 9001, 14001, 45001 & NABL / 17025 Certified Organisation)

Report No: GCI/V/Lab/EM-SP/22-23/May-00/0878

Date: 16/05/2022

## ANALYSIS REPORT

Client details		Sample Details	
Name	Residential Project by Prakruti Construction Pvt. Ltd.	Sample Code	GCI/V/22/E03/AA3
Address	F.P.NO. 105, S. NO. 343/2, Tadiwala Road , Pune	Location	SOUTHWEST CORNER OF SITE
		Date of Sampling	09/05/2022
Sampling Done By	Mr.Kartik	Date of Sample Received	10/05/2022
Analysis Starts On	10/05/2022	Sampling Instrument	RDS, FPS
Analysis Completion On	14/05/2022	Sampling Method	IS 5182 : Part 5 : 1975

## AMBIENT AIR ANALYSIS RESULTS

Sr. No.	Parameters	Unit	Results	National Ambient Air Quality Standards (NAAQS) amended 2009	Reference Method
1	Particulate Matter (PM <sub>10</sub> )	µg/m <sup>3</sup>	65.5	100	IS 5182 : Part 23 : 2006
2	Particulate Matter (PM <sub>2.5</sub> )	µg/m <sup>3</sup>	53.4	60	NAAQS Guidelines
3	Sulphur dioxide (SO <sub>2</sub> )	µg/m <sup>3</sup>	22.7	80	IS 5182 : Part 2 : 2001
4	Oxides of Nitrogen (NO <sub>x</sub> )	µg/m <sup>3</sup>	18.4	80	IS 5182 : Part 6 : 2006
5	Carbon Monoxide CO	mg/m <sup>3</sup>	0.16	2.0	IS 5182 : Part 10 : 1999
6	Ozone as O <sub>3</sub>	µg/m <sup>3</sup>	17.1	100	NAAQS Guidelines
7	Lead as Pb	µg/m <sup>3</sup>	BDL (<0.1)	1.0	NAAQS Guidelines
8	Nickel as Ni	ng/m <sup>3</sup>	BDL (<1)	20	NAAQS Guidelines
9	Arsenic as As	ng/m <sup>3</sup>	BDL (<1)	6.0	NAAQS Guidelines
10	Ammonia as NH <sub>3</sub>	µg/m <sup>3</sup>	3.7	400	NAAQS Guidelines
11	Benzene , C <sub>6</sub> H <sub>6</sub>	µg/m <sup>3</sup>	BDL (<0.01)	5.0	IS 5182 (Part 11):2006
12	Benzo (a) Pyrene	ng/m <sup>3</sup>	BDL (<0.1)	1.0	Gas Chromatography



Authorized Signatory

- Analysis is subject to the condition in which the sample is received at our Laboratory.
- Reports cannot be used as evidence anywhere including judiciary purpose without our prior permission.
- Sample will be retained till one month from the date of sampling.

CORP. OFFICE & : Green Empire (Anupushpam), Above AXIS Bank, Nr. Yash Complex, Gotri Main Road, Vadodara - 390 021 (Gujarat), INDIA.  
R & D Tel.: +91 - 265 - 2371269 Cell: +91 93285 83835 Email: info@greencircleinc.com Website: www.greencircleinc.com

NEW DELHI GOA PUNE BENGALURU U.K. : ALSO AT : HYDERABAD KOLKATA DHARWAD MUMBAI PORT BLAIR  
AUSTRALIA OMAN KUWAIT AFRICA : OVERSEAS : VIETNAM BANGLADESH MYANMAR SRI LANKA UAE





# GREEN CIRCLE, INC.

Integrated HSEQR Consulting Engineers, Scientists & Trainers  
(Recognised By Ministry of Environment, Forest and Climate Change, New Delhi Under EPA 1986)  
(F. No. - 15018 / 06 / 2016 - CPW)  
(ISO 9001, 14001, 45001 & NABL / 17025 Certified Organisation)

Report No: GCI/V/Lab/EM-SP/22-23/May-00/0878

Date: 16/05/2022

## ANALYSIS REPORT

Client Details		Sample Details	
Name	Residential Project by Prakruti Construction Pvt. Ltd.	Sample Code	GCI/V/22/E03/N-N3
Address	F.P.NO. 105, S. NO. 343/2, Tadiwala Road, Pune	Location	As per table
		Quantity	NA
		Date of Measurement	09/05/2022
		Sampling Instrument	Sound Level Meter (HTC/SL-1352)
Measurement Done By	Mr. Kartik	Sampling Method	HTC/SL-1352 Inst. Manual

## NOISE MONITORING RESULTS

Sr. No.	Location Name	Units	Day Time		Night Time	
			Results	MPCB Permissible Limit	Results	MPCB Permissible Limit
1	Near Security Gate	dB (A)	54.5	55	41.2	45
2	Southwest Corner of the Site	dB (A)	55.6	55	38.5	45
3	Northeast Corner of the Site	dB (A)	50.2	55	40.3	45

**Limits:** Maharashtra pollution Control Board has prescribed 55 dB (A) as an upper limit of noise level during day time and 45 dB (A) during night time for residential area.



Authorized Signatory

- Analysis is subject to the condition in which the sample is received at our Laboratory.
- Reports cannot be used as evidence anywhere including judiciary purpose without our prior permission.
- Sample will be retained till one month from the date of sampling.

**CORP. OFFICE & R & D** : Green Empire (Anupushpam), Above AXIS Bank, Nr. Yash Complex, Gotri Main Road, Vadodara - 390 021 (Gujarat), INDIA.  
Tel.: +91 - 265 - 2371269 Cell: +91 93285 83835 Email: info@greencircleinc.com Website: www.greencircleinc.com

**ALSO AT :**  
NEW DELHI GOA PUNE BENGALURU U.K. HYDERABAD KOLKATA DHARWAD MUMBAI PORT BLAIR  
**OVERSEAS :**  
AUSTRALIA OMAN KUWAIT AFRICA VIETNAM BANGLADESH MYANMAR SRI LANKA UAE



# GREEN CIRCLE, INC.

Integrated HSEQR Consulting Engineers, Scientists & Trainers  
(Recognised By Ministry of Environment, Forest and Climate Change, New Delhi Under EPA 1986)  
(F. No. - 15018 / 06 / 2016 - CPW)  
(ISO 9001, 14001, 45001 & NABL / 17025 Certified Organisation)

Report No: GCI/V/Lab/EM-SP/22-23/May-00/0878

Date: 16/05/2022

## ANALYSIS REPORT

Client Details		Sample Details	
Name	Residential Project by Prakruti Construction Pvt. Ltd.	Sample Code	GCI/V/22/E03/S1
		Location	SOIL – Project site
Address	F.P.NO. 105, S. NO. 343/2, Tadiwala Road , Pune	Quantity	2.0 kg
		Sampling Done By Mr. Kartik	
Analysis Starts on		10/05/2022	Date of Sampling
Analysis Completion On		14/05/2022	09/05/2022
		Sample Received Date	10/05/2022

## SOIL ANALYSIS RESULTS

Sr. No.	Parameter	Unit	Results	Test Procedure
1	pH (1:5 Soil Suspension)	-	7.2	IS 2720 (Part 26):1987
2	Electrical Conductivity (1:5 Soil Suspension)	mS/cm	0.45	EPA Method 9045
3	Total Nitrogen as N	mg/kg	62.3	Kjeldahl Method
4	Phosphate as P	mg/kg	BDL(<0.5)	Olsen Method
5	Potassium as K	mg/kg	6.5	EPA 3050 B
6	Exchangeable Calcium as Ca	meq/100g	231	EPA 3050 B
7	Exchangeable Magnesium as Mg	meq/100g	108	EPA3050 B
8	Exchangeable Sodium as Na	meq/100g	89	EPA3050 B
9	Organic Matter	%	46	Walkey and Black Method
10	Texture	-	Sandy Clay	Robinson Pipette Method

BDL =Below Detectable Limit

DL =Detectable Limit



Authorized Signatory

- Analysis is subject to the condition in which the sample is received at our Laboratory.
- Reports cannot be used as evidence anywhere including judiciary purpose without our prior permission.
- Sample will be retained till one month from the date of sampling.

CORP. OFFICE & : Green Empire (Anupushpam), Above AXIS Bank, Nr. Yash Complex, Gotri Main Road, Vadodara - 390 021 (Gujarat), INDIA.  
R & D Tel.: +91 - 265 - 2371269 Cell: +91 93285 83835 Email: info@greencircleinc.com Website: www.greencircleinc.com

NEW DELHI GOA PUNE BENGALURU U.K. : ALSO AT : HYDERABAD KOLKATA DHARWAD MUMBAI PORT BLAIR  
: OVERSEAS : AUSTRALIA OMAN KUWAIT AFRICA VIETNAM BANGLADESH MYANMAR SRI LANKA UAE



# GREEN CIRCLE, INC.

Integrated HSEQR Consulting Engineers, Scientists & Trainers  
(Recognised By Ministry of Environment, Forest and Climate Change, New Delhi Under EPA 1986)  
(F. No. - 15018 / 06 / 2016 - CPW)  
(ISO 9001, 14001, 45001 & NABL / 17025 Certified Organisation)

Report No: GCI/V/Lab/EM-SP/22-23/May-00/0878

Date: 16/05/2022

## ANALYSIS REPORT

Client Details			Sample Details	
Name	Residential Project by Prakruti Construction Pvt. Ltd.		Sample Code	GCI/V/22/E03/DW1
Address	F.P.NO. 105, S. NO. 343/2, Tadiwala Road , Pune		Location	Municipal Water at Project Site
			Quantity	2000 ml
Sampling Done By		Mr. Kartik	Date of Sampling	09/05/2022
Analysis Starts on		10/05/2022	Sampling Method	APHA 1060
Analysis Completion On		14/05/2022	Sample Received Date	10/05/2022

### DRINKING WATER ANALYSIS RESULTS

Sr. No.	Parameter	Unit	Results	Permissible Limit as per IS 10500-2012	Reference Method
1	Colour	Hazen	Nil	5	APHA 22nd EDITION
2	Odour	-	No Odour	Unobjectionable	APHA 22nd EDITION
3	Taste	-	Agreeable	Agreeable	APHA 22nd EDITION
4	Turbidity	NTU	BDL (<0.5)	1	IS : 3025 Part 10-1984 (Reaff: 2002)
5	pH at 25 °C	-	6.5	6.5-8.5	IS : 3025 Part 11- 1983 (Reaff:2002)
6	Total Dissolved Solids	mg/l	231	500	IS : 3025 Part 16-1984 (Reaff:2003)
7	Total Alkalinity as CaCO <sub>3</sub>	mg/l	95	200	IS : 3025 Part 23- 986(Reaff:2003)
8	Total Hardness as CaCO <sub>3</sub>	mg/l	87	200	IS : 3025 Part 21-2009
9	Calcium as Ca	mg/l	45	75	IS : 3025 Part 40-1991 (Reaff:2003)
10	Magnesium as Mg	mg/l	20	30	APHA 22nd EDITION-3500 Mg-B
11	Chloride as Cl <sup>-</sup>	mg/l	92	250	IS : 3025 Part 32-1988 (Reaff:2003)
12	Sulphate as SO <sub>4</sub>	mg/l	83	200	APHA 22nd EDN-4500- SO <sub>4</sub> - E
13	Nitrate as NO <sub>3</sub>	mg/l	28	45	APHA 22nd EDN -4500- NO <sub>3</sub> - B
14	Iron as Fe	mg/l	0.18	0.30	IS : 3025 Part 53-2003
15	Manganese as Mn	mg/l	BDL (<0.02)	0.10	APHA 22nd EDN -3500-Mn D
16	Fluoride as F	mg/l	0.52	1.00	APHA 22nd EDN -4500-F B&D
17	Lead as Pb	mg/l	BDL (<0.03)	0.05	IS:3025 Part 47 (Reaff:2003)
18	Copper as Cu	mg/l	BDL (<0.03)	0.05	IS:3025 Part 42 (Reaff:2003)
19	Zinc as Zn	mg/l	0.81	5.00	IS:3025 Part:49 (Reaff:2003)
20	Hexavalent Chromium as Cr <sup>6+</sup>	mg/l	BDL (<0.03)	0.05	IS:3025 Part:37 (Reaff:2003)
21	Residual Free Chlorine as Cl <sub>2</sub>	mg/l	BDL (<0.10)	0.20	APHA 22nd EDN -4500-Cl B
22	Cadium as Cd	mg/l	BDL (<0.03)	0.003	IS:3025 Part 48(Reaff:2003)
23	Aluminium	mg/l	BDL (<0.03)	0.03	IS:3025 Part:55 (Reaff:2003)

BDL =Below Detectable Limit



Authorized Signatory

- Analysis is subject to the condition in which the sample is received at our Laboratory.
- Reports cannot be used as evidence anywhere including judiciary purpose without our prior permission.
- Sample will be retained till one month from the date of sampling.

CORP. OFFICE & : Green Empire (Anupushpam), Above AXIS Bank, Nr. Yash Complex, Gotri Main Road, Vadodara - 390 021 (Gujarat), INDIA.  
R & D Tel.: +91 - 265 - 2371269 Cell: +91 93285 83835 Email: info@greencircleinc.com Website: www.greencircleinc.com

NEW DELHI GOA PUNE BENGALURU U.K. : ALSO AT : HYDERABAD KOLKATA DHARWAD MUMBAI PORT BLAIR  
: OVERSEAS : AUSTRALIA OMAN KUWAIT AFRICA VIETNAM BANGLADESH MYANMAR SRI LANKA UAE





# GREEN CIRCLE, INC.

Integrated HSEQR Consulting Engineers, Scientists & Trainers  
(Recognised By Ministry of Environment, Forest and Climate Change, New Delhi Under EPA 1986)  
(F. No. - 15018 / 06 / 2016 - CPW)  
(ISO 9001, 14001, 45001 & NABL / 17025 Certified Organisation)

Report No: GCI/V/Lab/EM-SP/22-23/May-00/0878

Date: 16/05/2022

## ANALYSIS REPORT

Client Details			Sample Details	
Name	Residential Project by Prakruti Construction Pvt. Ltd.		Sample Code	GCI/V/22/E03/M1
Address	F.P.NO. 105, S. NO. 343/2, Tadiwala Road , Pune		Location	Manure sample of OWC
			Quantity	2.0 kg
Sampling Done By		Mr. Kartik	Date of Sampling	09/05/2022
Analysis Starts on		10/05/2022		
Analysis Completion On		14/05/2022	Sample Received Date	10/05/2022

### MANURE ANALYSIS RESULTS

Sr. No.	Parameter	Unit	Results	Limits as per FCO	Test Procedure
1	pH	-	7.1	6.5-7.5	IS 2720 (Part 26):1987
2	Moisture	%	18.2	<25	IS 2720 – Part – 2
3	Odour	-	Absence of Foul Smell	Absence of Foul smell	In house
4	Colour	-	Blackish Brown	Dark brown to Black	In house
5	Bulk Density	g/cm <sup>3</sup>	0.44	<1.0	IS: 2720-P-28-1974
6	Total Organic Carbon	%	23.2	>14.0	IS 2720 : Part 22 : 1972
7	Total Nitrogen as N	mg/kg	1.6	>0.8	Kjeldahl Method
8	Phosphate as P	mg/kg	0.4	>0.4	Olsen Method
9	Potassium as K	mg/kg	0.8	>0.4	EPA 3050 B
10	C:N ratio	-	14.5	<20:1	-
11	Particle Size	-	87 % pass through 4mm Sieve	Min 90% material pass through 4mm IS sieve	IS: 2720-P4-1985



Authorized Signatory

- Analysis is subject to the condition in which the sample is received at our Laboratory.
- Reports cannot be used as evidence anywhere including judiciary purpose without our prior permission.
- Sample will be retained till one month from the date of sampling.

CORP. OFFICE & : Green Empire (Anupushpam), Above AXIS Bank, Nr. Yash Complex, Gotri Main Road, Vadodara - 390 021 (Gujarat), INDIA.  
R & D Tel.: +91 - 265 - 2371269 Cell: +91 93285 83835 Email: info@greencircleinc.com Website: www.greencircleinc.com

NEW DELHI GOA PUNE BENGALURU U.K. : ALSO AT : HYDERABAD KOLKATA DHARWAD MUMBAI PORT BLAIR  
AUSTRALIA OMAN KUWAIT AFRICA : OVERSEAS : VIETNAM BANGLADESH MYANMAR SRI LANKA UAE



कार्यकारी अभियंता कार्यालय

बंडगार्डन पाणी पुरवठा

पुणे महानगरपालिका

जावक क्र 1194

दिनांक 7/09/19

PROVISIONAL ENVIRONMENT CERTIFICATE

प्रती,

केवलकुमार केसरीमल जैन

प्रकृति कन्स्ट्रक्शन प्रा. लि

कुमार कॅपिटल

पुणे ४११००९

विषय :- केवलकुमार केसरीमल जैन, तर्फे प्रकृति कन्स्ट्रक्शन प्रा. लि यांनी स.न. ३४३/२, फायनल प्लॉट नं. १०५, संगमवाडी, टी.पी.एस. पुणे, येथील होणाऱ्या निवासी/व्यवसायिक प्रकल्पासाठी पर्यावरण नाहरकत प्रमाण पत्रासाठी पाणी पुरवठा विभागाचे अभिप्राय बाबत.

संदर्भ :- बंडगार्डन पाणी पुरवठा, आवक. क्र.११८८ दि. २६/०७/२०१९

संदर्भाकीत पत्रान्वये विषयांकीत नियोजित प्रकल्पास पुणे मनपा बांधकाम कमिन्समेंट सर्टीफिकेट क्रमांक सी.सी/४०५६/१८ दिनांक २७/०३/२०१९ नुसार पर्यावरण नाहरकत पत्र मिळणेसाठी पाणी पुरवठा विभागाचा ना-हरकत दाखल्याची मागणी आपण केली आहे. सदर प्रकल्पासाठी अंदाजे १८२ के.एल.डी इतक्या पाण्याची गरज असल्याचे पत्रात नमूद केले आहे. त्याअनुषंगाने खालील १ ते १३ अटीचे अधीन राहून पाणी पुरवठा विभागाचा ना हरकत दाखला देत आहोत.

- १) विषयांकीत मिळकतीवरील प्रकल्पास भोगवटा पत्र प्राप्त झाल्यानंतर भोगवटा असणाऱ्या प्रकल्पास यांचे प्रमाणात पाणी पुरवठा करणे करिता नळजोड प्रस्ताव सादर करणार.
- २) विकसकाने स्वखर्चाने मनपाचे सुचनेनुसार जलवाहिनी विकसित करणार.
- ३) एस.टी.पी बाबत स्वतंत्र माहिती खात्यास सादर करणार व त्याद्वारे पुर्नवापर होणाऱ्या पाण्याबाबतचा सविस्तर तपशील देणार.
- ४) जागेवर बांधकाम चालू करणेपूर्वी मिळकतीमधील मनपाच्या नळजोडावरील थकबाकी भरून सदर नळजोड बंद करणार.
- ५) इमारतीचे पिण्याचे पाणी, वापराचे पाणी व फ्लशिंगचे पाणी इ. कारणासाठी प्रत्येक प्रकल्पातील सदनिका/ऑफीसेस साठी स्वतंत्र व्यवस्था करणार.
- ६) सदर प्रकल्पाकरीता पाण्याचे उपलब्धेनुसार होणारा पाणी पुरवठा वगळता जादा पाण्याची व्यवस्था विकसक स्वतःकरावी लागेल.
- ७) अंतर्गत वापरण्यात येणा-या फिटींग्ज डिस्चार्ज ५ लिटर प्रति मिनिटापेक्षा कमी ठेवणार.
- ८) सर्व कामे सक्षम कन्सलटंट यांचेकडून डिझाईन करून त्यांचे सुपरव्हिजन अंतर्गत पूर्ण करणार.
- ९) व्यापारी पाणी वापरासाठी स्वतंत्र संपवेल बांधणार.
- १०) तत्कालीन पाण्याच्या परिस्थितीनुसार मनपा कडील नियमानुसार व धोरणानुसार या पुढील कार्यवाही तत्कालीन वेळी निश्चित करण्यात येईल.
- ११) भोगवटा पत्र प्राप्त झाल्यानंतर व भोगवटा पत्राच्या सदनिका/ऑफीसेसच्या प्रमाणात त्यावेळच्या प्राप्त धोरणानुसार पाणी पुरवठा उपलब्ध केला जाईल.
- १२) ले आऊट मनपा मान्य झाल्यानंतर सी.सी. ची एक प्रत व ले आऊटची एक प्रत खात्यास सादर करावी लागेल.
- १३) सदर प्रकरणी अपुऱ्या पाणी पुरवठ्याबाबत विकसक हे खात्याकडे सादर केलेल्या हमीपत्रास (नोटरी संगिता एस. धंगेकर (येर्नाले) यांचे नोटरी रजिस्टर क्र 280/2019 दिनांक २२/०७/२०१९) अधीन राहणार आहे

कळावे.

कनिष्ठ अभियंता

बंडगार्डन पाणी पुरवठा

पुणे महानगरपालिका

उप अभियंता

बंडगार्डन पाणी पुरवठा

पुणे महानगरपालिका

कार्यकारी अभियंता

बंडगार्डन पाणी पुरवठा

पुणे महानगरपालिका

ड्रेनेज पुर्तता पत्र

कै. बा. स. ढोले पाटील रोड, क्षेत्रीय  
पुणे महानगरपालिका.

जावक क्र. :- 360 दि. 26/12/2003

प्रति,

श्री. / श्रीमती विमल कुमार क. जे. जे.  
इरा - पी. एल. जे. 306 नारायण पेठ पुणे

यांस ---

महाशय,

पुणे पेठ नारायण पेठ टी. पी. स्कीम सन 2005 लाईव्हिंगरेड फायनल प्लॅन 905  
येथील ड्रेनेज पुर्तता पत्र मिळण्याबाबतचा आपला आ. क्र. 868 दि. 22/12/2003  
चा अर्ज पोहोचला.

सदर ठिकाणी ड्रेनेज संबंधी सर्व कामे नियमाप्रमाणे केल्याचा लायसेन्स  
दाखल आपण दाखल केलेला आहे. त्यावस्तु पाहणी करून खाली नमुद केलेले  
इमारतीचे भागाचे ड्रेनेज पुर्तता पत्र देण्यात येत आहे.

- ① विंग रा-1 - 8< फ्लॅट्स, 90 हुकाने पाकींग सह संपूर्ण
- ② विंग रा-2 - 8< फ्लॅट्स, 90 हुकाने पाकींग सह संपूर्ण
- ③ विंग रा-3 - 8< फ्लॅट्स, 90 हुकाने पाकींग सह संपूर्ण

तरी वर नमुद केलेल्या इमारतीचे/इमारतीच्या भागास बांधकाम  
खाल्याकडून भोगवटा पत्र मिळण्यास ड्रेनेज दृष्ट्या या विभागाची हरकत न  
करावे.

  
सहाय्यक अभियंता,

कै. बा. स. ढोले पाटील रोड,  
क्षेत्रीय कार्यालय पुणे महानगरपालिका.

प्रत - मा. सहा. अभियंता, [बांधकाम नियंत्रण]

पुणे महानगरपालिका.

इनेज पुर्तता पत्र

कै.बा.स.होले पाटील रोड, क्षेत्रिय कार्यालय  
पुणे महानगरपालिका

जाचक क्र. 3344 3344

दिनांक :- 23/3/04

प्रति,

वही कै जैन (P.A.M.)  
C/O लो.स. डोशी, पी.एस. अख्य  
२९६ बाराधन पोस्ट पुणे ४०

महाशय

पुणे नेज संशोधनारी श्री. पी. स्क्रीम-५२६/१२/२००५  
येथील इनेज पुर्तता पत्र मिळण्याबाबतचा आ.क्र. ५०२७ दि. ०१/३/०४ चा अर्ज पोहोचला.

रादर ठिकाणी हे नेज संबंधी नियमाप्रमाणे केल्याचा लायरोसचा दाखला आपण दाखल केलेला आ  
त्यावरून पाहणी करून खाली नमुद केलेल्या इमारतीचे भागाचे इनेज पुर्तता पत्र देण्यात येत आहे.

फोमोन्टोर सरी फोकेट क्र CC/०९०३/०४ दि ०३/०६/०४

- १) लोन्ग मजला - पार्किंग
- २) पहिली मजला - सहा फ्लॅट्स
- ३) दुसरी मजला - सहा फ्लॅट्स
- ४) तिसरी मजला - सहा फ्लॅट्स
- ५) चौथी मजला - सहा फ्लॅट्स
- ६) पाचवा मजला - सहा फ्लॅट्स
- ७) सहावा मजला - सहा फ्लॅट्स
- ८) सातवा मजला - सहा फ्लॅट्स
- ९) आठवा मजला - सहा फ्लॅट्स
- १०) नववा मजला - सहा फ्लॅट्स

राकून ५४ फ्लॅट्स

सहस्रपुर्ण इमारती

तरी वर नमुद केलेल्या इमारतीचे / इमारतीच्या भागास बांधकाम नियंत्रण खात्याकडून भोगवटा पत्र  
मिळण्यास इनेजदृष्ट्या या विभागाची हरकत नाही.

कळवे.

सहाय्यक अभियंता

कै.बा.स.होले पाटील रोड, क्षेत्रिय कार्यालय

पुणे महानगरपालिका.

प्रत:- मा.सहा.अभियंता (बांधकाम नियंत्रण)  
पुणे महानगरपालिका.

(29-2003)

Out W. No. : FE/ 885

Date : 23/7/2003

To,  
Pandit Joshi & Associates,  
Architects,  
216, Narayan peth,  
Pune-30.

Sub. : Final N.O.C. for proposed building at S.No.343/2,  
F.P.No.105, Tadiwala Road, Sangamwadi, Pune.  
(For wings A-1, A-2 & A-3 only)

Ref. : Your office letter, Dtd. 19.7.2003.

Sir,

Mr. Patil on 23.7.2003

As per your referred letter, visited the proposed site along with ~~xx~~ and  
tested the hydrant system / ~~hose reel system~~ Manual call point with P.A. & Detection system  
with equipments and portable fire extinguishers  
~~suggested in model N.O.C. Form~~ as per discussion.

~~All the suggestions made in model N.O.C. Form are carried out to our satisfaction and~~  
I have no objection to use the building for proposed purpose.

All the fire fighting equipments and systems installed in the building should be  
maintained in high efficiency state and in proper working order at all time during the use  
of the building by owner or occupier.

Yearly inspection of the fire protection system shall be carried out by this office.

Name of the person, owner, society responsible for the maintenance should be informed  
to this office.

Fire protection system provided in the building should not be removed from the  
building for any reason.

This no objection is subjected to any other conditions laid by any other department.

Plot area 12943.86 sqm.  
Total builtup area of wing A-1,  
A-2 & A3 = 9142.67 sqm.  
Height of the Bldg. 27.21 mtrs.  
Hard ship is paid by (1) Ch.No.7765,  
Dt.17.9.2001; Rs.72,904/- (2) Ch.No.  
5559, Dt.27.5.2002, Rs.10,520/- (3)  
Ch.No.184276, Dt.22.3.2002, Rs.64,400/-

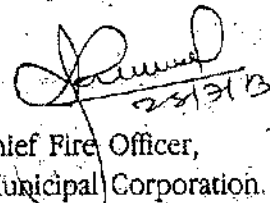
  
Chief Fire Officer,  
Pune Municipal Corporation.

Copy to : Asst. Engineer (B.C.)  
Pune Municipal Corporation.

File NOC - Raju

नोंदणी क्रमांक पीएलओ/पीएलके (२४)  
एचएसजी/८ टिक्की/७०६७/०८६०१



सत्यमेव जयते

महाराष्ट्र शासन

## नोंदणीचे प्रमाणपत्र

या प्रमाणपत्राद्वारे प्रमाणित करण्यात येत आहे की  
~~कुमार पिनेकर सहकारी गृहनिर्माण संस्था मर्यादित संस्थेने~~  
३४३ सिटीएस १४ फायनल फ्लॅट नं. १०५ टीपीएस संगमवाडी  
पुणे ४११००९  
ही संस्था महाराष्ट्र सहकारी संस्थांचे अधिनियम, १९६०  
मधील (सन १९६१ चा महाराष्ट्र अधिनियम क्रमांक २४)  
कलम ९ (१) अन्वये नोंदण्यात आलेली आहे.

उपरिनिर्दिष्ट अधिनियमाच्या कलम १२ (१) अन्वये  
व महाराष्ट्र सहकारी संस्थांचे नियम क्रमांक १० (१) अन्वये  
संस्थेचे वर्गीकरण "गृहनिर्माण संस्था" असून  
उपवर्गीकरण "ग्रामेरु, स्वतःचाजिदारी गृहनिर्माण संस्था" आहे.

कार्यालयीन मोहोर

स्थळ

पुणे

दिनांक : ११/११/२००४



सही

स्नेहालीचव्ठ डाकूर

हस्ता

पनिबंधक, सहकारी संस्था

पुणे शहर (२) पुणे



### **Budget for Environment Management Plan**

#### **Construction Phase:**

<b>Sr. No.</b>	<b>Attributes</b>	<b>Parameter</b>	<b>Total cost in Lakhs per annum</b>
1	Air environment	Water For Dust Suppression	2.0
2	Air Environment	Air & Noise Monitoring	
3	Water Environment	Tanker Water For Construction & Water Monitoring	2.5
4	Land Environment	Site Sanitation	1.5
5	Socioeconomic Environment	Disinfection- Pest Control, First Aid Facilities, Health Check Up, Personal Protective Equipment	4.5
6	Environment Monitoring	Air,water ,Noise & DG stack monitoring	2.0
		<b>Total Cost</b>	<b>12.5</b>

#### **Operation Phase:**

<b>Sr. No.</b>	<b>Component</b>	<b>Pollution Control Measures</b>	<b>Capital Cost (Rs. Lakhs)</b>	<b>Recurring Cost Per Annum (Rs. Lakhs)</b>
1.	Waste water Management	Sewage Treatment Plant	22.40	7.80
2.	Rain Water Harvesting	No. of pits	5	0.75
3.	Solid Waste	To assure proper disposal of Dry and Wet Waste, 1 no OWC will be provided	14.75	2.80
4.	Landscaping	Plantation & gardening	10.0	1.8
5.	Energy saving	With all said energy saving measures like solar panels and solar water heaters	52.36	1.30
6.	Environmental Monitoring	Air, Noise, Water, Effluent tests as per government norms	-	2.5
		<b>Total</b>	<b>104.51</b>	<b>16.95</b>

**राधाकृष्ण विखे-पाटील 'डेंजर झोन'मध्ये**

**मल**  
विश्लेषण

Vijaysinh.Holam  
@tunegroup.com

मगर : सुप्रीदोरच नगर निवास्त  
एकन एक हुन्नी नुनै कोशी  
माले जा नुनै व तता पारे  
केल्सा रफ्तानुन पाला विधि  
रोम्मायि परेया नगला रोने. यकर  
मगर कल्पसाय व विहास्त नुनै  
कोशी नुनै विमिग कल्पसायि  
काजयन जवर्किया पकड  
झकिपया पयन सारफान विसे  
नैने डेला. मगर, जित्स् पुरो  
'अकर्मनु' असेले. यकड  
कविस्ते अण्डय मगर पकर  
विसे हा हा हा हा हा हा हा हा.  
एकडे नडे त निवास्त आँय  
रनखरच एकराकाला विसे अला  
'देनर झीन मये जकन पाले'  
होने. विहास्तु सारफा गण्डय  
वडीने अने नो के के नो नो



विजयानंतर रोहित पंथार यांनी कर्जत शहरातून गुरुपारी गिरवणूक काढण्यात आली.

विश्वव्यापी एकताही नेतृत्व बरपावची, त्यामुळे राज्यातील राजकीय वजन कार्यवाहीची त्याची सुरुवात झाली होती. निव्वन्त १२-० (मरण) हे याचा भाव्य-सोनेला किंजल देण्याची धोखा त्यांनी देली. निव्वन्ताला सर्व मत्तदारांभोवत लक्ष्या चालनाला भाव्यपत्राच्या जागी त्यांनी देण्याची विनम्र

संस्थानाचा विकास करण्यासाठी प्रत्येक कर्मचा-  
रानेदेखील मिळवलेल्या केंद्रांना मतदानातून  
बाहेरील धर्चा रस्त्या दाखवली आहे.  
संस्थानातील जवळ २५ जगापैकी जवळपास  
निष्ठा अर्थात पराभवाची धन वास्तवी  
लगावी आहे.

विजयनगरा निजदुसरीच्य जोड्यार  
देवी कर्मिणपैल ३८ मतबर पुज्यार्नी  
सतापारी फावप उठिण शिस्तोनेन प्रेस  
करुन अमेदवारी परतत पावुन पोतुनी  
लेवी त्यातरी १६ उपकारुन माताप्रीत  
धर्चा रस्त दमकुविला आठे. फातार  
वेलेल्या नेर्याची पाटी पावत. अद्यायुन  
युतीफये गेलेल्या नेर्याचये कन्याफये  
गेलेल्या नेर्याचये पातये प्राणप जाला  
अतुन. शिस्तोनेन गेलेल्या नेर्याच

[illegible]

यूय कसू- राकल, दलौ तकरायाय  
 बाऊ नरु- तर लूबनी तकरायाय  
 अथिअर मतराया मतराया बाखरी  
 कडो वणीयू 'वलीगी' कोगीनी  
 नाती भणजेय 'जेव' हा पर्याया  
 तपर करणूया आला. या पर्यायाय  
 मतराणी ते लोकाय लोकराया आणि  
 मुन्वाडी पिचल लागलेय विपराय  
 निवडणुकीयाय मोठड प्राणय कर  
 लेय आले. अनेक मतरासंभाय  
 'नौय' ला पिचलेय. मताडी  
 आकडेनी हरागीय धराल आले.  
 कडो मतरासंभाय 'नौय' ने काती  
 दिगय लेवनी नौदार कूटका दिला  
 आले. त्यापय पत्तू प्राणीय, पलू-  
 कडाय आणि पलूय मतरासंभाय

हजार २७१ मतदारशीं निवडणुकीत नापाकीं दहावंत 'नेट'चे बटम दाखविणारंसा मतदारसंघातून कोसिलेचें बटम यांनी १,४१,४१० मते मिळाले विला प्रमुख संजय विठ्ठले यांना बटम यांनी १, ६१,२१२ मतांपेक्षा मतदारसंघात दुसऱ्या क्रमांकाची २०

प्रामुख्याने उल्लेख करिता लागले.

नेट्या माथल्या आकडेवारीत नापाकीं राष्ट्रीय विधानसभे मतदारसंघे चवथे विषय उरल आले. ते उद्योगां दिशंत, मनी नीलसंघी विलसत, दिसामुख यांचे पुत्र धीरज विलसामुख, त विषयान आगमर जंकां पिये येळक

तुम्हें उष्ण असलेल्या प्रत्येक उपवेदबाराताने, सांगली विद्यालयात पसतून कडेपावत असलेल्या शिष्यांना आम्हावर विस्मयित करीत. जडमय यांच्या विरोधाभासात शिष्यांमध्ये केवळ टक्कलच होते मिळवता आली. तेव्हा ते शिष्या मिळविलेला आहे. यज्ञ, या १९३९ मी 'नेत्या'ला मिळविली आहेत.

अत्यंत निरी लढत रंगली होती. बायको धीराने देहापुत्रा सजीवक मोठे मिळवून विजयनी आहे. मान यांच्या हातमोठ्यात मत्तपुत्रांनी 'नेत्या'चा परीक्षा पारती दिली. या मतपुत्रमोठ्या लढतून पारित १९४१ मत्तपुत्रांनी 'नेत्या'चा परीक्षा सजीवकाने आहे.

A screenshot of a mobile application interface. On the left, there is a vertical list of items, each with a small icon and text. To the right of this list is a large, light gray rectangular area. On the far right, there are two rounded rectangular buttons, each containing the text 'MO'.

नौकरी शोभनाय? सेल्स/मार्केटिंग  
जीव पढनाय?

**ताहीर मुय्या**

आपरी, प्रकृति केन्द्रावली प्रा. कार्यलय पता: बार्ड रोड डेप्टन, २४२/३, सा. २२, बंगल, पुणे-४२२००५, भारत नवरोड कलुनी डेप्टन की, महाराष्ट्र सरकारया  
पर्यावरण संरक्षण आणखी ऑफिस ३.३०५, मॉडर्न २, २४२/३, ताहिकला रोड,  
सोमनाथकली, पुणे येथील नियमित कामकाज करायला रत. २५ ऑक्टोबर २०१५ रोजी  
प्रमाणे EC NO. SE/AA-EC-0000002051 या पर्यावरण विभाग यावतुन  
मंजुरी मिळी आहे. या मंजुरीची गरज महाराष्ट्र मुद्रण विभाग तिकळ त्यांच्या कार्यलयतून  
मंजुरी पर्यावरण विभाग, महाराष्ट्र सरकार येथे आहे

<http://www.ec.maharashtra.gov.in> या संकेतावलीत उपलब्ध आहे.

**प्रकृति केन्द्रावली प्रा. लि., पुणे**

हम फेस्टीव सिग्नलला जायते नवे कर आणि नवी कर खेदी करा!

**GOA STATE LOTTERIES**  
**RAJSHREE**  
**DIWALI BUMPER**  
**1st Prize**  
**₹5**



# PRAKRUTI CONSTRUCTIONS PVT. LTD.

REGISTERED ADDRESS : 21, HAZARIMAL SOMANI MARG, WAUDBY ROAD, OPP. BOMBAY GYM KHANA, FORT, MUMBAI - 400 001. TEL : 022-2209 4876 / 2209 4797

CORP. OFF. ADDRESS : KUMAR CAPITAL, 2413, EAST STREET, CAMP, PUNE - 411 001. TEL : 020 - 3052 8888 / 3058 3635

E-mail : contact@kumarworld.com Website : www.kumarworld.com CIN : U45200MH1993PTC075778 Date: 07/10/2020

To,  
Executive Engineer,  
Building Control Department,  
PMC, Pune

**Subject – Regarding submission of Environment Clearance copy of Residential project is being developed by Prakruti Constructions Pvt. Ltd.**

Dear Sir,

Prakruti Constructions Pvt. Ltd. is developing Residential project at F.P.no. 105, S. no. 343/2, Tadiwala Road, Sangamwadi, Tal Haveli, Pune, Maharashtra. The project has received Environment Clearance from State Environment Impact Assessment Authority (SEIAA) vide no. SEIAA-EC-0000002051 dated 22/10/2019. As per condition (LI) given in clearance letter we are herewith submitting Environment Clearance letter for your reference.

This is for your information and record.

Thank you.

Yours Faithfully,

For, Prakruti Constructions Pvt. Ltd.

## ANNEXURE

1. Environment Clearance copy

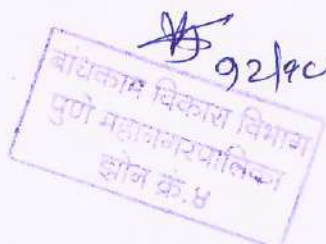



kumar properties &lt;kumarworldcompliance2025@gmail.com&gt;

---

**Six Monthly Compliance Report for period October 2021 to March 2022 for project \_Prakruti Constructions Pvt. Ltd.**

---

**kumar properties** <kumarworldcompliance2025@gmail.com>

Thu, Jun 2, 2022 at 5:24 PM

To: ecompliance-mh@gov.in

Bcc: Moef19@kumarworld.com

Dear Sir/Madam,

Please find the Post EC Compliance Report attached herewith for Period October 2021 to March 2022 of Residential project proposed on\_ F.P. no.105, S. no. 343/2, Tadiwala Road, Haveli, Pune, Maharashtra. , by Prakruti Constructions Pvt. Ltd.,with reference to Environmental Clearance Letter No. SEIAA-EC-0000002051 dated 22<sup>nd</sup> October 2019.

Hope this is in line with your requirement.

Thanking you

Yours Sincere

Prakruti Constructions Pvt. Ltd.

**Compliance report\_Pinacal\_Oct 2021 to March 2022.pdf**

12542K





# PRAKRUTI CONSTRUCTION PVT. LTD.

21, Hazarimal Somani Marg, Waudby Road, Bombay Gymkhana Fort, Mumbai - 400 001. Tel. : 022-22094876 / 22094797 Fax : 022-22094796

Date: 30/05/2022

To  
Chairman, SEIAA  
Environment Department,  
15<sup>th</sup> Floor, New Administrative Building,  
Mantralaya, Mumbai-400032

Sub: Post EC Compliance Report for Period of October 2021 to March 2022 of our Residential and Commercial Project at F.P. no.105, S. no. 343/2, Tadiwala Road, Haveli, Pune, Maharashtra being developed by Prakruti Constructions Pvt. Ltd.

Ref.: Environmental Clearance Letter No. SEIAA-EC-0000002051 dated 22nd October 2019.

Dear Sir/Madam

As per the condition laid down in the Environmental Clearance Letter, we are submitting herewith post EC compliance report of our Residential and Commercial Project for period of October 2021 to March 2022.

Hope this is in line with your requirement.

Thanking you,

For Prakruti Constructions Pvt. Ltd.

CC: 1. MPCB -Member Secretary, Kalpataru Point, 3<sup>rd</sup> and 4<sup>th</sup> floor, Opp. Cine Planet, Sion Circle, Sion, Mumbai, Maharashtra 400022.

By  
13/06/22  
महाराष्ट्र प्रदूषण नियंत्रण मंडळ  
कल्पतरु पॉइंट, २ रा मजला, सायन सर्कल,  
सिनेप्लेनेट समोर, सायन (पूर्व),  
मुंबई - ४०० ०२२.  
फोन :- २४०९०४३७ / २४०२०७८९  
Website www.mpcb.gov.in



# PRAKRUTI CONSTRUCTION PVT. LTD.

21, Hazarimal Somani Marg, Waudby Road, Bombay Gymkhana Fort, Mumbai - 400 001. Tel. : 022-22094876 / 22094797 Fax : 022-22094796

**Date: 30/05/2022**

To  
Chairman, SEIAA  
Environment Department,  
15<sup>th</sup> Floor, New Administrative Building,  
Mantralaya, Mumbai-400032

Sub: Post EC Compliance Report for Period of October 2021 to March 2022 of our Residential and Commercial Project at F.P. no.105, S. no. 343/2, Tadiwala Road, Haveli, Pune, Maharashtra being developed by Prakruti Constructions Pvt. Ltd.

Ref.: Environmental Clearance Letter No. SEIAA-EC-0000002051 dated 22nd October 2019.

Dear Sir/Madam

As per the condition laid down in the Environmental Clearance Letter, we are submitting herewith post EC compliance report of our Residential and Commercial Project for period of October 2021 to March 2022.

Hope this is in line with your requirement.

Thanking you,

For Prakruti Constructions Pvt. Ltd.

CC: 1. MPCB -Member Secretary, Kalpataru Point, 3<sup>rd</sup> and 4<sup>th</sup> floor, Opp. Cine Planet, Sion Circle, Sion, Mumbai, Maharashtra 400022.

*13-6-22*  
आयक लापक (नं. शा.)  
पयावरण व वातावरण बंदल विभाग  
मंत्रालय, मुंबई ४०० ०३२





# PRAKRUTI CONSTRUCTIONS PVT. LTD.

REGISTERED ADDRESS : 21, HAZARIMAL SOMANI MARG, WAUDBY ROAD, OPP. BOMBAY GYM KHANA, FORT, MUMBAI - 400 001. TEL : 022-2209 4876 / 2209 4797

CORP. OFF. ADDRESS : KUMAR CAPITAL, 2413, EAST STREET, CAMP, PUNE - 411 001. TEL : 020 - 3052 8888 / 3058 3635

E-mail : contact@kumarworld.com Website : www.kumarworld.com CIN : U45200MH1993PTC075778 Date: 07/10/2020

To,  
Executive Engineer,  
Building Control Department,  
PMC, Pune

Subject – Regarding submission of Environment Clearance copy of Residential project is being developed by Prakruti Constructions Pvt. Ltd.

Dear Sir,

Prakruti Constructions Pvt. Ltd. is developing Residential project at F.P.no. 105, S. no. 343/2, Tadiwala Road, Sangamwadi, Tal Haveli, Pune, Maharashtra. The project has received Environment Clearance from State Environment Impact Assessment Authority (SEIAA) vide no. SEIAA-EC-0000002051 dated 22/10/2019. As per condition (LI) given in clearance letter we are herewith submitting Environment Clearance letter for your reference.

This is for your information and record.

Thank you.

Yours Faithfully,

For, Prakruti Constructions Pvt. Ltd.

## ANNEXURE

1. Environment Clearance copy

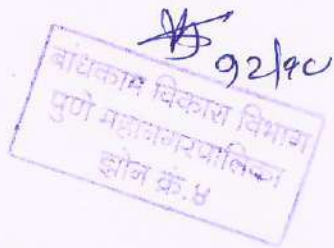



kumar properties &lt;kumarworldcompliance2025@gmail.com&gt;

---

## Six Monthly Compliance Report for period April 2021 to September 2021 for project \_Prakruti Constructions Pvt. Ltd.

---

kumar properties &lt;kumarworldcompliance2025@gmail.com&gt;

Tue, Dec 28, 2021 at 1:25 PM

To: ecompliance-mh@gov.in

Bcc: Moef19@kumarworld.com

Dear Sir/Madam,

Please find the Post EC Compliance Report attached herewith for Period April 2021 to September 2021 of Residential project proposed on\_ F.P. no.105, S. no. 343/2, Tadiwala Road, Haveli, Pune, Maharashtra. , by Prakruti Constructions Pvt. Ltd.,with reference to Environmental Clearance Letter No. SEIAA-EC-0000002051 dated 22<sup>nd</sup> October 2019.

Hope this is in line with your requirement.

Thanking you  
Yours Sincere

Prakruti Constructions Pvt. Ltd.



**Compliance report\_Pinacal\_ April 2021 to September 2021.pdf**  
14051K



## PRAKRUTI CONSTRUCTIONS PVT. LTD.

REGISTERED ADDRESS : 21, HAZARIMAL SOMANI MARG, WAUDBY ROAD, OPP. BOMBAY GYMKHANA, FORT, MUMBAI - 400 001. TEL. : 022-2209 4876 / 2209 4797  
CORP. OFF. ADDRESS : KUMAR CAPITAL, 2413, EAST STREET, CAMP, PUNE - 411 001. TEL. : 020 - 3052 8888 / 3058 3635  
E-mail : contact@kumarworld.com Website : www.kumarworld.com CIN : U45200MH1993PTC075778

Date: 27/12/2021

To  
Chairman, SEIAA  
Environment Department,  
15th Floor, New Administrative Building,  
Mantralaya, Mumbai-400032

Sub: Post EC Compliance Report for Period of April 2021 to September 2021 of our Residential at F.P. no.105, S. no. 343/2, Tadiwala Road, Haveli, Pune, Maharashtra deing developed by Prakruti Constructions Pvt. Ltd.

Ref.: Environmental Clearance Letter No. SEIAA-EC-0000002051 dated 22nd October 2019.

Dear Sir/Madam

As per the condition laid down in the Environmental Clearance Letter, we are submitting herewith post EC compliance report of our Residential project for period of April 2021 to September 2021.

Hope this is in line with your requirement.

Thanking you

**SAMIR  
SHAMKANT  
PATIL**

Digitally signed by  
SAMIR SHAMKANT  
PATIL  
Date: 2022.01.01  
11:48:34 +05'30'

For, Prakruti Constructions Pvt. Ltd.

*Handwritten signature*  
4-1-22  
आवक लिपीक  
पर्यावरण विभाग  
मुंबई

CC: 1.MPCB -Member Secretary, Kalpataru Point, 3rd and 4th floor, Opp. Cine Planet, Sion Circle, Sion, Mumbai, Maharashtra 400022.



## PRAKRUTI CONSTRUCTIONS PVT. LTD.

REGISTERED ADDRESS : 21, HAZARIMAL SOMANI MARG, WAUDBY ROAD, OPP. BOMBAY GYMKHANA, FORT, MUMBAI - 400 001. TEL : 020-2209-4326 / 2209-4794  
CORP. OFF. ADDRESS : KUMAR CAPITAL, 2413, EAST STREET, CAMP, PUNE - 411 001. TEL : 020-3052 8880 / 3056 3838  
E-mail : contact@kumarworld.com Website : www.kumarworld.com CIN : U45200MH1803PTC075778

Date: 27/12/2021

To  
Chairman, SEIAA  
Environment Department,  
15th Floor, New Administrative Building,  
Mantralaya, Mumbai-400032

Sub: Post EC Compliance Report for Period of April 2021 to September 2021 of our Residential at F.P. no.105, S. no. 343/2, Tadiwala Road, Haveli, Pune, Maharashtra being developed by Prakruti Constructions Pvt. Ltd.

Ref.: Environmental Clearance Letter No. SEIAA-EC-0000002051 dated 22nd October 2019.

Dear Sir/Madam

As per the condition laid down in the Environmental Clearance Letter, we are submitting herewith post EC compliance report of our Residential project for period of April 2021 to September 2021.

Hope this is in line with your requirement.

Thanking you

SAMIR  
SHAMKANT  
PATIL

Digitally signed by  
SAMIR SHAMKANT  
PATIL  
Date: 2022.01.01  
11:48:34 +05'30'

For, Prakruti Constructions Pvt. Ltd.

*Pur*  
महाराष्ट्र प्रदूषण नियंत्रण मंडळ  
कल्पतारु पॉइंट, २ रा मजला, सायन सर्कल,  
सिनेप्लेनट समोर, सायन (पूर्व),  
मुंबई - ४०० ०२२.  
फोन :- २४०९०४३७ / २४०२०७८९  
Website : www.mpcb.gov.in

CC: 1.MPCB -Member Secretary, Kalpataru Point, 3rd and 4th floor, Opp. Cine Planet, Sion Circle, Sion, Mumbai, Maharashtra 400022.





## Congratulation

Document uploaded successfully

## MPCB Documents

Sr No.	Document Name	Document Category	Date	Action
1	Scrutiny-Letter-21-Jan-2020	Other	21-01-2020	<a href="#">Download</a>   <a href="#">Message</a>
2	visit report	Visit Report	24-01-2020	<a href="#">Download</a>   <a href="#">Message</a>
3	Scrutiny-Letter-27-Jan-2020	Other	27-01-2020	<a href="#">Download</a>   <a href="#">Message</a>
4	Scrutiny-Letter-04-Feb-2020	Other	04-02-2020	<a href="#">Download</a>   <a href="#">Message</a>

## Uploaded documents

Sr No.	Document Category	Document Name	Date	Action
1	Industry Registration	Industry Registration	12-12-2019	<a href="#">Download</a>
2	Other	Annexure 1 to 5 for Reply Scrutiny Letter 21-jan-2020	28-01-2020	<a href="#">Download</a>
3	Other	Affidavit	27-01-2021	<a href="#">Download</a>
4	Land Ownership Certificate	Land Document	12-12-2019	<a href="#">Download</a>
5	Other	Six Monthly Report-Pinnacle- April to Sept 2020	01-12-2020	<a href="#">Download</a>
6	Other	Six monthly Compliance report_Pinnacle_Oct 2019 to March 2020	22-07-2020	<a href="#">Download</a>
7	Detailed proposal of pollution control system	Details of pollution control system	12-12-2019	<a href="#">Download</a>
8	Other	Architect Certificate with existing and proposed BUA	20-02-2020	<a href="#">Download</a>
9	CA Certificate   Balance Sheet   Capital Investment	CA Certificate	12-12-2019	<a href="#">Download</a>
10	Manufacturing Process	Manufacturing process	12-12-2019	<a href="#">Download</a>
11	Other	Reply to Scrutiny Letter 21-jan-2020	28-01-2020	<a href="#">Download</a>
12	Other	Six Monthly Compliance report -Pinnacle- October 2020 to March 2021	17-06-2021	<a href="#">Download</a>

## My Documents

**Note:** For infrastructure projects submit architecture area statement additionally.

**Note:** If project attracts EIA notifications submit environmental clearance copy and for infrastructure project environmental clearance & architect completion certificate.

## Upload New

**Note:** Document must be in pdf format and size must be less than 2MB

Document Type \*

Select Type of document ▼

Document Name \*

Choose File

No file chosen



Enter the code above here :

[Upload](#) [Back](#)





# PRAKRUTI CONSTRUCTIONS PVT. LTD.

REGISTERED ADDRESS : 21, HAZARIMAL SOMANI MARG, WAUDBY ROAD, OPP. BOMBAY GYMKHANA, FORT, MUMBAI - 400 001. TEL : 022-2263 4575 / 2269 4787  
CORP. OFF. ADDRESS : KUMAR CAPITAL, 2413, EAST STREET, CAMP, PUNE - 411 001. TEL : 020 - 3052 8888 / 3058 3635  
E-mail : contact@kumarworld.com Website : www.kumarworld.com CIN : U45200MH1993PTC075778

Date: 31/08/2021

To  
Chairman, SEIAA  
Environment Department,  
15th Floor, New Administrative Building,  
Mantralaya, Mumbai-400032

Sub: Post EC Compliance Report for Period of October 2020 to March 2021 of our Residential project at F.P. no.105, S. no. 343/2, Tadiwala Road, Haveli, Pune, Maharashtra by Prakruti Constructions Pvt. Ltd.

Ref.: Environmental Clearance Letter No. SEIAA-EC-0000002051 dated 22nd October 2019.

Dear Sir/Madam

As per the condition laid down in the Environmental Clearance Letter, we are submitting herewith post EC compliance report of our Residential project for period of October 2020 to March 2021.

Hope this is in line with your requirement.

Thanking you

Yours Sincere

SAMIR  
SHAMKANT  
PATIL

Digitally signed by  
SAMIR SHAMKANT  
PATIL  
Date: 2021.08.31  
17:32:03 +05'30'

For, Prakruti Constructions Pvt. Ltd.

CC: 1.MPCB -Member Secretary, Kalpataru Point, 3rd and 4th floor, Opp. Cine Planet, Sion Circle, Sion, Mumbai, Maharashtra 400022.

महाराष्ट्र प्रदूषण नियंत्रण मंडळ  
कल्पतरु पॉइंट, २ रा मजला, सायन सर्कल,  
सिनेप्लेनट समोर, सायन (पूर्व),  
मुंबई - ४०० ०२२.  
फोन :- २४०५०४३७ / २४०२०७८९  
Website www.mpcb.gov.in



# PRAKRUTI CONSTRUCTIONS PVT. LTD.

REGISTERED ADDRESS : 21, HAZARIMAL SOMANI MARG, WAUDBY ROAD, OPP. BOMBAY GYM KHANA, FORT, MUMBAI - 400 001. TEL : 022-2206 4875 / 2206 4876  
CORP. OFF. ADDRESS : KUMAR CAPITAL, 2413, EAST STREET, CAMP, PUNE - 411 001. TEL : 020 - 3052 8888 / 3058 3636  
E-mail : contact@kumarworld.com Website : www.kumarworld.com CIN : U45200MH1993PTC075778

Date: 31/08/2021

To  
Chairman, SEIAA  
Environment Department,  
15th Floor, New Administrative Building,  
Mantralaya, Mumbai-400032

Sub: Post EC Compliance Report for Period of October 2020 to March 2021 of our Residential project at F.P. no.105, S. no. 343/2, Tadiwala Road, Haveli, Pune, Maharashtra by Prakruti Constructions Pvt. Ltd.

Ref.: Environmental Clearance Letter No. SEIAA-EC-0000002051 dated 22nd October 2019.

Dear Sir/Madam

As per the condition laid down in the Environmental Clearance Letter, we are submitting herewith post EC compliance report of our Residential project for period of October 2020 to March 2021.

Hope this is in line with your requirement.

Thanking you

Yours Sincere

SAMIR  
SHAMKANT  
PATIL  
Digitally signed by  
SAMIR SHAMKANT  
PATIL  
Date: 2021.08.31  
17:32:03 +05'30'

For, Prakruti Constructions Pvt. Ltd.

*Mawar*  
7/9/21

आवरक लिपिक (नॉ.शा.)  
वातावरण व वातावरणाव बद्दल विभाग  
मंत्रालय, मुंबई ४०० ०३२

CC: 1.MPCB -Member Secretary, Kalpataru Point, 3rd and 4th floor, Opp. Cine Planet, Sion Circle, Sion, Mumbai, Maharashtra 400022.



kumar properties &lt;kumarworldcompliance2025@gmail.com&gt;

---

**Six Monthly Compliance Report for period October 2020 to March 2021 for project \_Prakruti Constructions Pvt. Ltd.**

1 message

---

**kumar properties** <kumarworldcompliance2025@gmail.com>

Wed, Jun 16, 2021 at 3:57 PM

To: ecompliance-mh@gov.in

Bcc: Moef19@kumarworld.com

Dear Sir/Madam,

Please find the Post EC Compliance Report attached herewith for Period October 2020 to March 2021 of Residential project proposed on\_ F.P. no.105, S. no. 343/2, Tadiwala Road, Haveli, Pune, Maharashtra. , by Prakruti Constructions Pvt. Ltd.,with reference to Environmental Clearance Letter No. SEIAA-EC-0000002051 dated 22<sup>nd</sup> October 2019.

Hope this is in line with your requirement.

Thanking you

Yours Sincere

Prakruti Constructions Pvt. Ltd.

**Compliance report\_Pinacal\_ Oct 2020 to Mar 2021.pdf**

10698K



kumar properties &lt;kumarworldcompliance2025@gmail.com&gt;

---

## Six Monthly Compliance Report for period April 2020 to September 2020 for project \_Prakruti Constructions Pvt. Ltd.

---

kumar properties &lt;kumarworldcompliance2025@gmail.com&gt;

Tue, Dec 1, 2020 at 4:22 PM

To: ecompliance-mh@gov.in

Bcc: Moef19@kumarworld.com

Dear Sir/Madam,

Please find the Post EC Compliance Report attached herewith for Period April 2020 to September 2020 of Residential project proposed on\_ F.P. no.105, S. no. 343/2, Tadiwala Road, Haveli, Pune, Maharashtra. , by Prakruti Constructions Pvt. Ltd.,with reference to Environmental Clearance Letter No. SEIAA-EC-0000002051 dated 22<sup>nd</sup> October 2019.

Hope this is in line with your requirement.

Thanking you  
Yours Sincere

Prakruti Constructions Pvt. Ltd.



---

**Compliance report\_Pinacal\_ April 2020 to September 2020.pdf**  
9376K



## Congratulation

Document uploaded successfully

## MPCB Documents

Sr No.	Document Name	Document Category	Date	Action
1	Scrutiny-Letter-21-Jan-2020	Other	21-01-2020	<a href="#">Download</a>   <a href="#">Message</a>
2	visit report	Visit Report	24-01-2020	<a href="#">Download</a>   <a href="#">Message</a>
3	Scrutiny-Letter-27-Jan-2020	Other	27-01-2020	<a href="#">Download</a>   <a href="#">Message</a>
4	Scrutiny-Letter-04-Feb-2020	Other	04-02-2020	<a href="#">Download</a>   <a href="#">Message</a>

## Uploaded documents

Sr No.	Document Category	Document Name	Date	Action
1	Manufacturing Process	Manufacturing process	12-12-2019	<a href="#">Download</a>
2	Other	Architect Certificate with existing and proposed BUA	20-02-2020	<a href="#">Download</a>
3	Other	Six Monthly Report-Pinnacle-April to Sept 2020	01-12-2020	<a href="#">Download</a>
4	Industry Registration	Industry Registration	12-12-2019	<a href="#">Download</a>
5	Other	Annexure 1 to 5 for Reply Scrutiny Letter 21-jan-2020	28-01-2020	<a href="#">Download</a>
6	Other	Reply to Scrutiny Letter 21-jan-2020	28-01-2020	<a href="#">Download</a>
7	Detailed proposal of pollution control system	Details of pollution control system	12-12-2019	<a href="#">Download</a>
8	CA Certificate   Balance Sheet   Capital Investment	CA Certificate	12-12-2019	<a href="#">Download</a>
9	Land Ownership Certificate	Land Document	12-12-2019	<a href="#">Download</a>
10	Other	Six monthly Compliance report_Pinnacle_Oct 2019 to March 2020	22-07-2020	<a href="#">Download</a>

## My Documents

**Note:** For infrastructure projects submit architecture area statement additionally.

**Note:** If project attracts EIA notifications submit environmental clearance copy and for infrastructure project environmental clearance & architect completion certificate.

## Upload New

**Note:** Document must be in pdf format and size must be less than 2MB

Document Type \*

Select Type of document ▼

Document Name \*

Choose File

[Choose File](#)

No file chosen



Enter the code above here :

[Upload](#) [Back](#)



# PRAKRUTI CONSTRUCTION PVT. LTD.

Kumar Capital, 1st Floor, 2413, East Street, Camp, Pune - 411 001, India. Tel. : 30528888, 30583663

Date: 08/12/2020

To  
Chairman, SEIAA  
Environment Department,  
15<sup>th</sup> Floor, New Administrative Building,  
Mantralaya, Mumbai-400032

Sub: Post EC Compliance Report for Period of April to September 2020 of our Residential at F.P. no.105, S. no. 343/2, Tadiwala Road, Haveli, Pune, Maharashtra being developed by Prakruti Constructions Pvt. Ltd.

Ref.: Environmental Clearance Letter No. SEIAA-EC-0000002051 dated 22nd October 2019.

Dear Sir/Madam

As per the condition laid down in the Environmental Clearance Letter, we are submitting herewith post EC compliance report of our Residential project for period of April to September 2020.

Hope this is in line with your requirement.

Thanking you,

*Sandeep*

For, Prakruti Constructions Pvt. Ltd.

15/12/20  
महाराष्ट्र प्रदूषण नियंत्रण मंडळ,  
राज्य शाखा, १५ वीं फ्लोर, नवी प्रशासकीय इमारत,  
मंत्रालय, मुंबई - ४०००३२  
फोन: २४०१०९३९/२४०२०९८९

CC: 1.MPCB -Member Secretary, Kalpataru Point, 3<sup>rd</sup> and 4<sup>th</sup> floor, Opp. Cine Planet, Sion Circle, Sion, Mumbai, Maharashtra 400022.

# PRAKRUTI CONSTRUCTION PVT. LTD.

Kumar Capital, 1st Floor, 2413, East Street, Camp, Pune - 411 001, India, Tel. : 30528888, 30583663

To  
Chairman, SEIAA  
Environment Department,  
15<sup>th</sup> Floor, New Administrative Building,  
Mantralaya, Mumbai-400032

Date: 08/12/2020

पेग  
15.12.20  
आवक लिपिक (नॉ.शा.)  
पर्यावरण व वातावरणाय बदल विभाग  
मंत्रालय, मुंबई ४०० ०३२

Sub: Post EC Compliance Report for Period of April to September 2020 of our Residential at F.P. no.105, S. no. 343/2, Tadiwala Road, Haveli, Pune, Maharashtra being developed by Prakruti Constructions Pvt. Ltd.

Ref.: Environmental Clearance Letter No. SEIAA-EC-0000002051 dated 22nd October 2019.

Dear Sir/Madam

As per the condition laid down in the Environmental Clearance Letter, we are submitting herewith post EC compliance report of our Residential project for period of April to September 2020.

Hope this is in line with your requirement.

Thanking you,

Sandeep

For, Prakruti Constructions Pvt. Ltd.

CC: 1.MPCB -Member Secretary, Kalpataru Point, 3<sup>rd</sup> and 4<sup>th</sup> floor, Opp. Cine Planet, Sion Circle, Sion, Mumbai, Maharashtra 400022.



## Congratulation

Document uploaded successfully

## MPCB Documents

Sr No.	Document Name	Document Category	Date	Action
1	Scrutiny-Letter-21-Jan-2020	Other	21-01-2020	<a href="#">Download</a>   <a href="#">Message</a>
2	visit report	Visit Report	24-01-2020	<a href="#">Download</a>   <a href="#">Message</a>
3	Scrutiny-Letter-27-Jan-2020	Other	27-01-2020	<a href="#">Download</a>   <a href="#">Message</a>
4	Scrutiny-Letter-04-Feb-2020	Other	04-02-2020	<a href="#">Download</a>   <a href="#">Message</a>

## Uploaded documents

Sr No.	Document Category	Document Name	Date	Action
1	Other	Reply to Scrutiny Letter 21-jan-2020	28-01-2020	<a href="#">Download</a>   <a href="#">Message</a>   <a href="#">Delete</a>
2	Land Ownership Certificate	Land Document	12-12-2019	<a href="#">Download</a>   <a href="#">Message</a>   <a href="#">Delete</a>
3	Other	Annexure 1 to 5 for Reply Scrutiny Letter 21-jan-2020	28-01-2020	<a href="#">Download</a>   <a href="#">Message</a>   <a href="#">Delete</a>
4	Detailed proposal of pollution control system	Details of pollution control system	12-12-2019	<a href="#">Download</a>   <a href="#">Message</a>   <a href="#">Delete</a>
5	Other	Architect Certificate with existing and proposed BUA	20-02-2020	<a href="#">Download</a>   <a href="#">Message</a>   <a href="#">Delete</a>
6	Other	Six monthly Compliance report_Pinnacle_Oct 2019 to March 2020	22-07-2020	<a href="#">Download</a>   <a href="#">Message</a>   <a href="#">Delete</a>
7	Industry Registration	Industry Registration	12-12-2019	<a href="#">Download</a>   <a href="#">Message</a>   <a href="#">Delete</a>
8	Manufacturing Process	Manufacturing process	12-12-2019	<a href="#">Download</a>   <a href="#">Message</a>   <a href="#">Delete</a>
9	CA Certificate   Balance Sheet   Capital Investment	CA Certificate	12-12-2019	<a href="#">Download</a>   <a href="#">Message</a>   <a href="#">Delete</a>

## My Documents

**Note:** For infrastructure projects submit architecture area statement additionally.

**Note:** If project attracts EIA notifications submit environmental clearance copy and for infrastructure project environmental clearance & architect completion certificate.

## Upload New

**Note:** Document must be in pdf format and size must be less than 2MB

Document Type \*

Select Type of document ▼

Document Name \*

Choose File

[Choose file](#) No file chosen



Enter the code above here :

Upload [Back](#)



kumar properties &lt;kumarworldcompliance2025@gmail.com&gt;

---

**Six Monthly Compliance Report for period October 2019 to March 2020 for project \_Prakruti Constructions Pvt. Ltd.**

---

**kumar properties** <kumarworldcompliance2025@gmail.com>

Mon, Jul 20, 2020 at 7:30 PM

To: ecompliance-mh@gov.in

Bcc: Moef19@kumarworld.com

Dear Sir/Madam,

Please find the Post EC Compliance Report attached herewith for Period October 2019 to March 2020 of Residential project proposed on\_ F.P. no.105, S. no. 343/2, Tadiwala Road, Haveli, Pune, Maharashtra. , by Prakruti Constructions Pvt. Ltd.,with reference to Environmental Clearance Letter No. SEIAA-EC-0000002051 dated 22<sup>nd</sup> October 2019.  
Hope this is in line with your requirement.

Thanking you  
Yours Sincere

Prakruti Constructions Pvt. Ltd.

**Compliance report\_Pinacal\_ Oct 2019to March 2020.pdf**  
8513K





# Maharashtra Pollution Control Board

महाराष्ट्र प्रदूषण नियंत्रण मंडळ

## FORM V

(See Rule 14)

Environmental Audit Report for the financial Year ending the 31st March 2022

### Unique Application Number

MPCB-ENVIRONMENT\_STATEMENT-0000050945

### Submitted Date

19-10-2022

## PART A

### Company Information

#### Company Name

Prakruti Constructions Pvt. Ltd.

#### Application UAN number

MPCB-CONSENT-0000084659

#### Address

Kumar Capital, 2413, East Street, Camp, Pune

#### Plot no

F.P.no. 105, S. no. 343/2, Tadiwala Road

#### Taluka

Haveli

#### Village

Sangamwadi

#### Capital Investment (In lakhs)

1058.00

#### Scale

L.S.I

#### City

Pune

#### Pincode

411001

#### Person Name

Mr. Samir Patil

#### Designation

Manager

#### Telephone Number

9011009240

#### Fax Number

#### Email

moef19@kumarworld.com

#### Region

SRO-Pune I

#### Industry Category

Orange

#### Industry Type

O21 Building and construction project more than 20,000 sq. m built up area

#### Last Environmental statement submitted online

yes

#### Consent Number

Format1.0/BO/JD(WPC)UAN-084659/CE/CC-2006000665

#### Consent Issue Date

2020-06-15

#### Consent Valid Upto

2025-06-14

#### Establishment Year

2019

#### Date of last environment statement submitted

Jan 1 1900 12:00:00:000AM

#### Industry Category Primary (STC Code) & Secondary (STC Code)

### Product Information

#### Product Name

NA

#### Consent Quantity

0

#### Actual Quantity

0

#### UOM

CMD

### By-product Information

#### By Product Name

NA

#### Consent Quantity

0

#### Actual Quantity

0

#### UOM

CMD

## Part-B (Water & Raw Material Consumption)

1) Water Consumption in m3/day

Water Consumption for Process	Consent Quantity in m3/day	Actual Quantity in m3/day
	0.00	0.00
Cooling	0.00	0.00
Domestic	57.00	0.00
All others	0.00	0.00
Total	57.00	0.00

2) Effluent Generation in CMD / MLD

Particulars	Consent Quantity	Actual Quantity	UOM
Domestic Effluent	51	0	CMD

2) Product Wise Process Water Consumption (cubic meter of process water per unit of product)

Name of Products (Production)	During the Previous financial Year	During the current Financial year	UOM
NA	0	0	CMD

3) Raw Material Consumption (Consumption of raw material per unit of product)

Name of Raw Materials	During the Previous financial Year	During the current Financial year	UOM
NA	0	0	CMD

4) Fuel Consumption

Fuel Name	Consent quantity	Actual Quantity	UOM
NA	0	0	CMD

Part-C

Pollution discharged to environment/unit of output (Parameter as specified in the consent issued)

[A] Water

Pollutants Detail	Quantity of Pollutants discharged (kL/day) Quantity	Concentration of Pollutants discharged(Mg/Lit) Except PH,Temp,Colour Concentration	Percentage of variation from prescribed standards with reasons %variation	Standard	Reason
NA	0	0	-	-	-

[B] Air (Stack)

Pollutants Detail	Quantity of Pollutants discharged (kL/day) Quantity	Concentration of Pollutants discharged(Mg/NM3) Concentration	Percentage of variation from prescribed standards with reasons %variation	Standard	Reason
NA	0	0	-	-	-

Part-D

HAZARDOUS WASTES

1) From Process

Hazardous Waste Type	Total During Previous Financial year	Total During Current Financial year	UOM
0	0	0	CMD

2) From Pollution Control Facilities

Hazardous Waste Type	Total During Previous Financial year	Total During Current Financial year	UOM
0	0	0	CMD

Part-E

SOLID WASTES

1) From Process

Non Hazardous Waste Type	Total During Previous Financial year	Total During Current Financial year	UOM
NA	0	0	CMD

2) From Pollution Control Facilities

Non Hazardous Waste Type	Total During Previous Financial year	Total During Current Financial year	UOM
NA	0	0	CMD

3) Quantity Recycled or Re-utilized within the unit

Waste Type	Total During Previous Financial year	Total During Current Financial year	UOM
0	0	0	CMD

Part-F

Please specify the characteristics(in terms of concentration and quantum) of hazardous as well as solid wastes and indicate disposal practice adopted for both these categories of wastes.

1) Hazardous Waste

Type of Hazardous Waste Generated	Qty of Hazardous Waste	UOM	Concentration of Hazardous Waste
0	0	CMD	-

2) Solid Waste

Type of Solid Waste Generated	Qty of Solid Waste	UOM	Concentration of Solid Waste
NA	0	CMD	-

Part-G

Impact of the pollution Control measures taken on conservation of natural resources and consequently on the cost of production.

Description	Reduction in Water Consumption (M3/day)	Reduction in Fuel & Solvent Consumption (KL/day)	Reduction in Raw Material (Kg)	Reduction in Power Consumption (KWH)	Capital Investment(in Lacs)	Reduction in Maintenance(in Lacs)
NA	0	0	0	0	0	0

Part-H

Additional measures/investment proposal for environmental protection abatement of pollution, prevention of pollution.  
[A] Investment made during the period of Environmental Statement

Detail of measures for Environmental Protection	Environmental Protection Measures	Capital Investment (Lacks)
Environment Monitoring	To monitor the environmental parameters.	0.85

---

**[B] Investment Proposed for next Year**

<b><i>Detail of measures for Environmental Protection</i></b>	<b><i>Environmental Protection Measures</i></b>	<b><i>Capital Investment (Lacks)</i></b>
Environment Monitoring	To monitor the environmental parameters.	0.85

**Part-I**

---

**Any other particulars for improving the quality of the environment.**

**Particulars**

NA

**Name & Designation**

Mr. Samir Patil

**UAN No:**

MPCB-ENVIRONMENT\_STATEMENT-0000050945

**Submitted On:**

19-10-2022