



On-location Image

On-location Image

On-location Image

AMENITIES

Clubhouse Complex-1 :

- Gymnasium (8.8m x 5.8m)
- Multipurpose Hall (8.8m x 14m)
- Swimming Pool (14m x 7.5m x 1.2m)
- Kids' Pool (10.5m x 4.5m x 0.45m)

Clubhouse Complex-2 :

- Gymnasium (6.32m x 11.94m)
- Multipurpose Hall (14.25m x 8.74m)
- Swimming Pool (14m x 7.5m x 1.2m)
- Kids' Pool (10.5m x 4.5m x 0.45m)

- Snooker Area (1 no.)
- Table Tennis (1 no.)
- Jogging Track (2 nos.)
- Cricket Nets (2 nos.)
- Tennis Court (1 no.)
- Basketball Court (1 no.)
- Badminton Courts (2 nos.)
- Kids' Zones (3 nos.)
- Amphitheatre (1 no.)
- Multipurpose Lawn (1 no., 77.1m x 31.5m)
- Maze Garden (1 no.)
- Garden Walkway (4 nos.)
- Water Bodies
- Sculptures & Statues

Provided for all Phases
(Existing, on-going
and proposed phases also)



On-location Image

SPECIFICATIONS

CONSTRUCTION

- A-class, earthquake-resistant construction.
- Entire building painted with acrylic paint of external grade.

ENTRANCE LOBBY

- Designer entrance lobby.

FLOORING

- 800 X 800 mm vitrified tiles in living, kitchen and bedrooms.
- Matt finish ceramic flooring in toilets.
- Anti-skid tiles for balconies/terraces.

DOORS AND WINDOWS

- Vinyl filmed flush door with SS fittings for entrance and bedrooms.
- HDF skin paneled flush door shutter with SS fitting for toilets.
- Powder coated aluminum sliding window.
- MS railing for attached terraces.

WALLS AND CEILINGS

- Gypsum punning on walls.
- OBD paint for walls and ceilings.

KITCHEN

- Granite kitchen counter.
- Stainless steel sink.
- Glazed tile dado on kitchen platform.
- Provision for water purifier and exhaust fan.

BATHROOMS AND TOILETS

- Concealed plumbing using CPVC piping.
- White/colored ceramic sanitaryware of reputed brand.
- Single lever diverter in shower areas along with single lever basin mixer for master bathroom and pillar cock for other bathrooms.
- Floor mounted WC with flush tank.
- 7' height toilet dado with ceramic tiles.
- Provision for boiler and exhaust fan in all toilets.

ELECTRICALS

- Concealed copper wiring in the entire apartment with ELCB and MCB switches in the distribution board.
- Modular electrical switches and sockets.
- Adequate points for lights, fans and TV.
- Telephone point in living and bedrooms.
- Provision for cable TV.
- Provision for split AC in living and master bedroom.

LIFTS

- Modern automatic lifts of reputed brand

SAFETY

- CCTV camera at ground floor entrance lobby.
- Eco-friendly systems.
- Sewage treatment plant.
- Rainwater harvesting.
- Water treatment plant.

PROJECT LAYOUT



Site : S. No. 214, 220, 221, Opp. Shiv Shankar Mangal Karyalaya, Phursungi Village, Tal. Haveli, Dist. Pune.

LOCATION



ARCHITECTS

Farhad T. Khareghat

RCC CONSULTANTS

Sunil Mutalik

LANDSCAPE DESIGN

Shobha Bhopatkar

DEVELOPERS

Kumar Properties & Real Estate Pvt. Ltd.



BUILDING TRUST & RELIABILITY SINCE 1966

CORPORATE OFFICE - PUNE : Kumar Capital, 2413, East Street, Camp, Pune - 411 001, India.

Tel : +91-20-3052 8888, 3058 3661/62 Fax : 2635 3365

MUMBAI : 21, Hazarimal Soman Marg, Waudby Road, Opp. Bombay Gymkhana, Fort, Mumbai - 400 001, India.

Tel : +91-22-2209 4876, 2209 4797 Fax : 2209 4796

BENGALURU : No. 33, Crescent Road, High Grounds, Opp. Taj West End Hotel - Back Gate, Bengaluru - 560 001, India. Tel : +91-80-4128 0992

Sales Enquiry : 9595 110011, 9595 660066, 9595 770077

E-mail : sales@kumarworld.com Website : www.kumarworld.com

www.parkinfinia.co.in

This brochure is purely conceptual and not a legal offering. All images given are only for visual reference. The company reserves the right to add, delete or alter any details/specifications/layout/floor plans/elevations/amenities/facilities in its endeavour to make improvements as and when required.

Where your mind sings
the tune of Nature!



park infinia

A park you'll call home

www.kumarworld.com / June 17



PHASE-III
2 Bedroom Spacious Apartments
Near SP Infocity, Phursungi

A garden township where you will experience the harmonious blend of Nature and modern amenities.

Advantageously located in Phursungi (off Pune-Solapur Highway), Park Infinia is close to SP Infocity (IT SEZ) – the IT hub that's home to many leading IT & software companies. Focused on Nature, the project offers aesthetically planned apartments, world-class amenities, breathtaking landscaping, beautiful parks and streetscapes merging seamlessly. Distinctly ahead of other projects, Park Infinia has close proximity to Pune's fast growing areas like Hadapsar, Mundhwa, Kharadi, Wanowrie and Undri.

One of the flagship projects of Kumar Properties, a brand backed by over 30,000 happy customers for excellence and reliability, Park Infinia is centered on bringing the best of living experience within an affordable budget. While more than 750 families at Park Infinia Phase-I and II enjoy its benefits and pleasures, the Phase-III is a golden opportunity for those who wish to live in a serene, peaceful yet potentially booming locale.

- Pleasant views of outside environment
- Large water bodies and maze gardens
- Pedestrian spines and garden walkway
- Dense perimeter landscape
- Holistic energy-efficient approach
- Conservation of scarce national resources



On-location Image

Building E1, F1, G1 & G4 • ODD FLOOR PLAN (P+12)

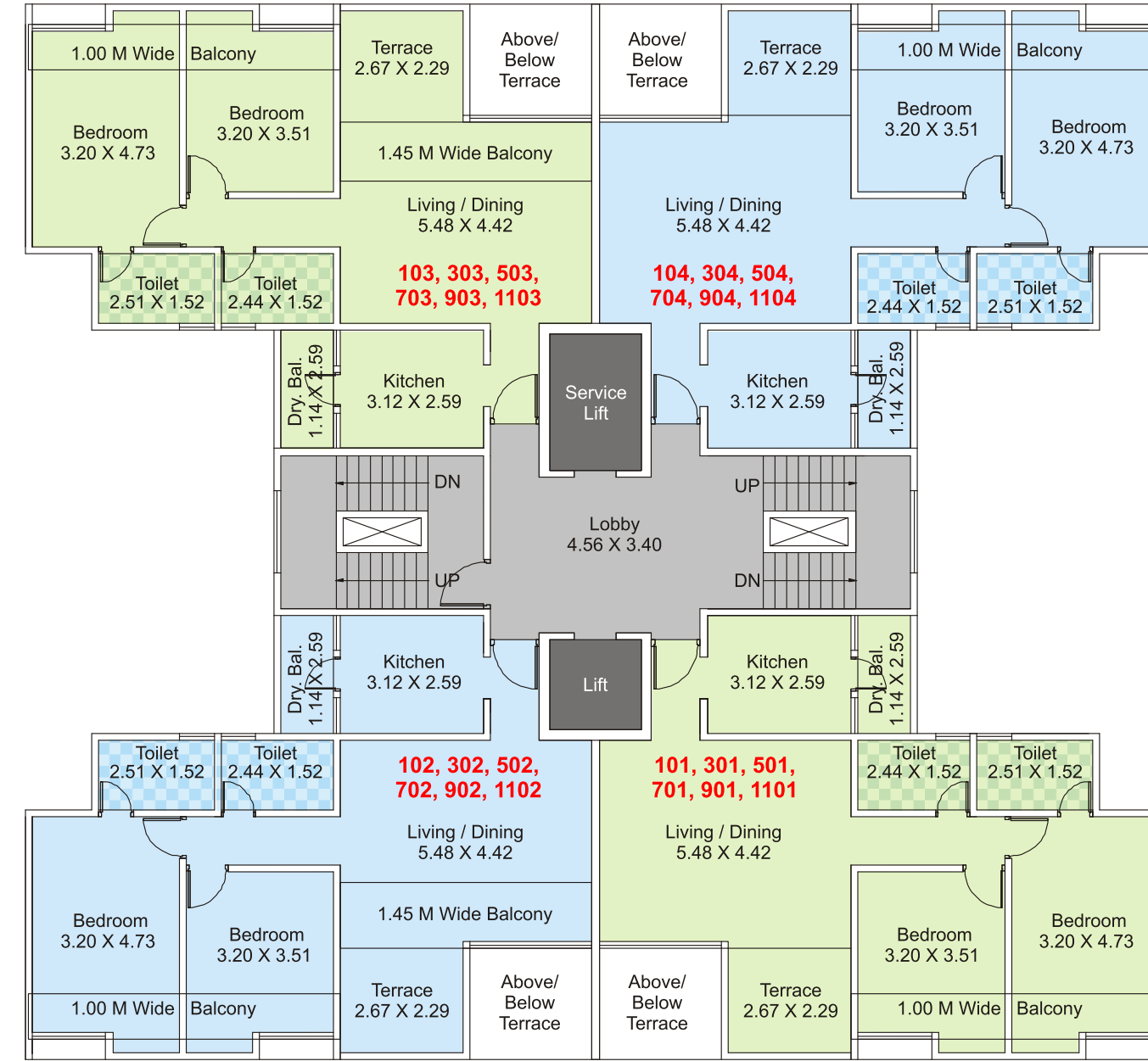

Apartment Nos.	Type	Carpet (sq.mtr.)	Enclosed Balcony (sq.mtr.)	Terrace (sq.mtr.)	Dry Balcony (sq.mtr.)
101, 104	2 BHK	71.050	6.019	5.970	2.830
102, 103	2 BHK	63.890	13.149	5.970	2.830



Building E1, F1, G1 & G4 • EVEN FLOOR PLAN (P+12)

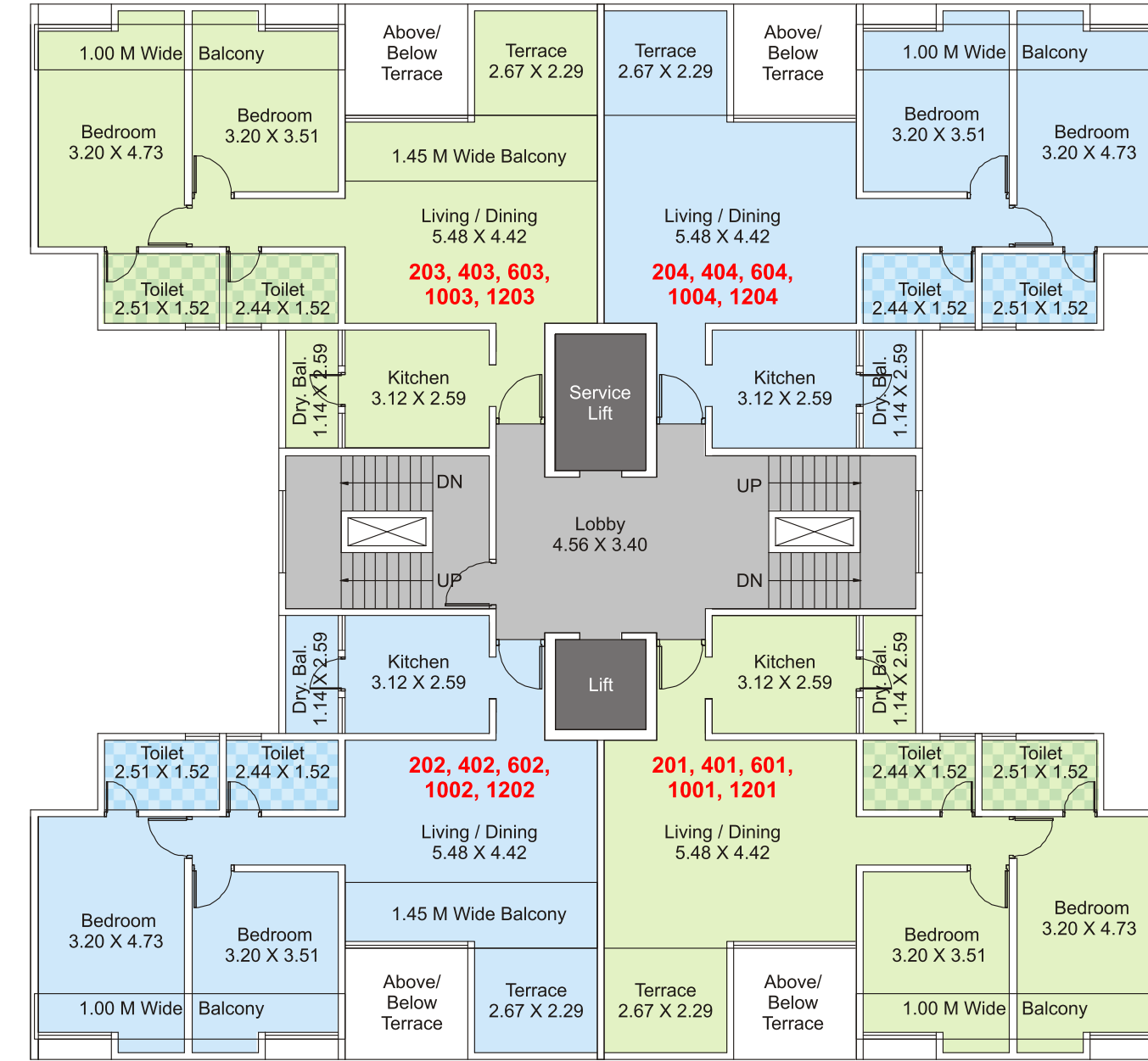

Apartment Nos.	Type	Carpet (sq.mtr.)	Enclosed Balcony (sq.mtr.)	Terrace (sq.mtr.)	Dry Balcony (sq.mtr.)
101, 104	2 BHK	71.050	6.019	5.970	2.830
102, 103	2 BHK	63.890	13.149	5.970	2.830



Building E1, F1, G1 & G4 • EIGHTH (REFUGE) FLOOR PLAN

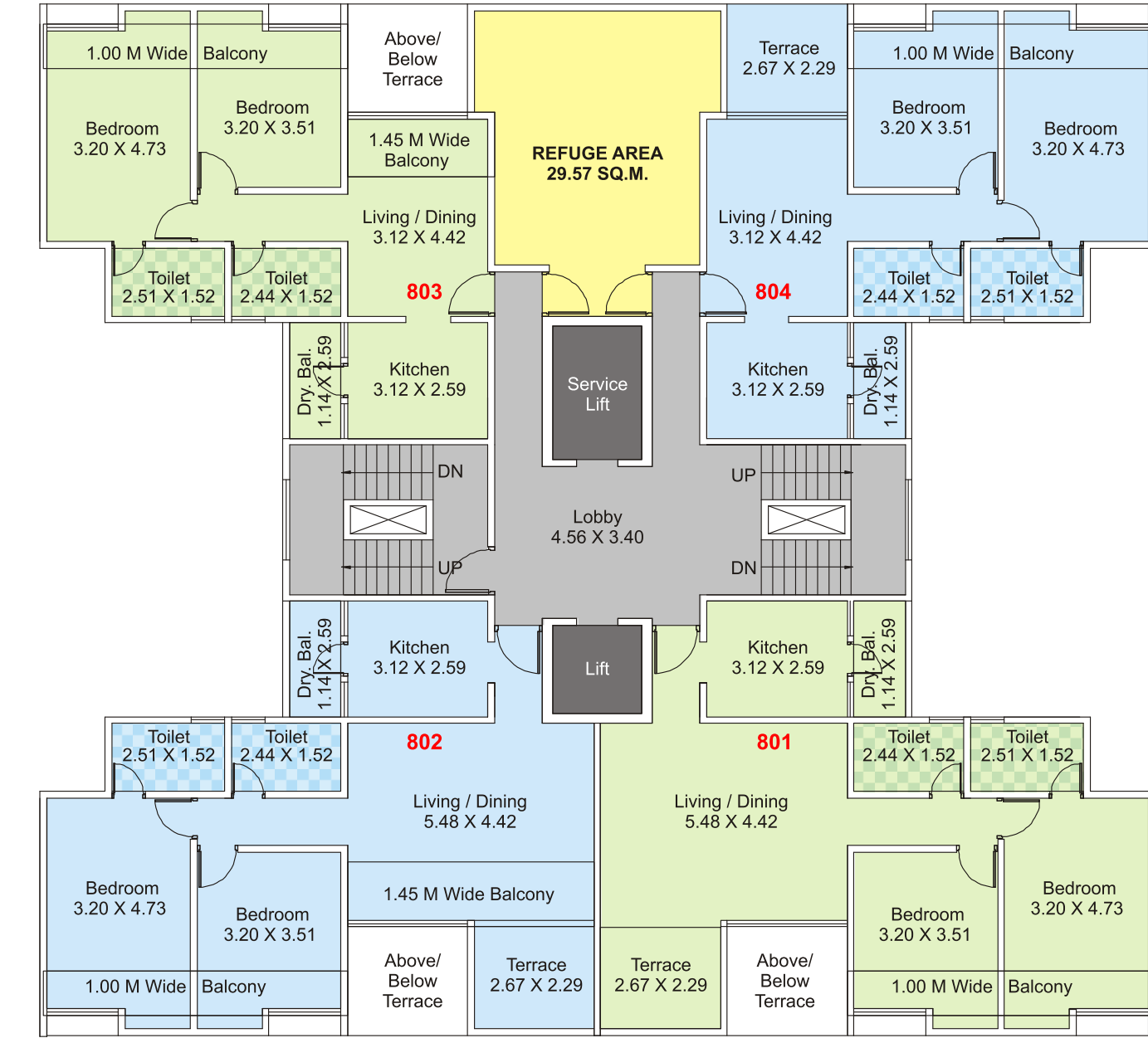

Apartment No.	Type	Carpet (sq.mtr.)	Enclosed Balcony (sq.mtr.)	Terrace (sq.mtr.)	Dry Balcony (sq.mtr.)
801	2 BHK	71.050	6.019	5.970	2.830
802	2 BHK	63.890	13.149	5.970	2.830
803	2 BHK	53.659	10.080	-	2.830
804	2 BHK	57.719	6.019	-	2.830



FLOOR PLANS



On-location Image



On-location Image



On-location Image