

FIRST FLOOR PLAN - B3



BLDG 'B3' 1ST FLOOR (AREA IN SQ.M.)			
UNIT PARTICULARS	CARPET	OPEN BAL.	TERRACE
101	75.00	5.50	16.50
102	75.50	5.50	26.50
103	75.00	5.50	24.10
104	74.50	5.50	15.90

TYPICAL FLOOR PLAN (2ND, 4TH, 6TH, 10TH) - B3



BLDG 'B3' TYP FLOOR (AREA IN SQ.M.)			
UNIT PARTICULARS	CARPET	OPEN BAL.	TERRACE
201, 202, 203, 204, 401, 402, 403, 404 601, 602, 603, 604, 1001, 1002, 1003, 1004,	73.00	5.50	0.00

TYPICAL FLOOR PLAN (3RD, 5TH, 7TH, 9TH, 11TH) - B3

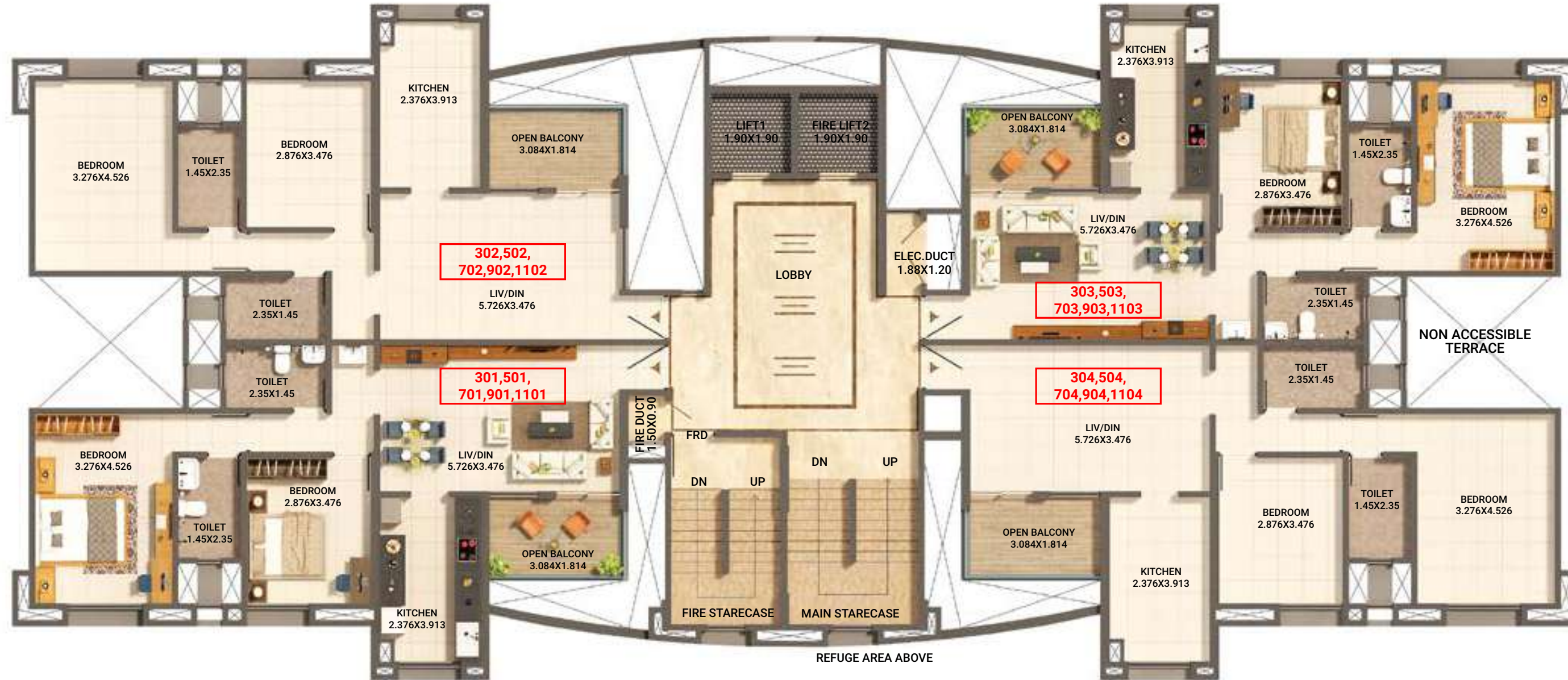

BLDG 'B3' TYP FLOOR (AREA IN SQ.M.)			
UNIT PARTICULARS	CARPET	OPEN BAL.	TERRACE
301, 302, 303, 304, 501, 502, 503, 504, 701, 702, 703, 704, 901, 902, 903, 904, 1101, 1102, 1103, 1104	73.00	5.50	0.00

REFUGE FLOOR PLAN (8TH) - B3



BLDG 'B3' REF FLOOR (AREA IN SQ.M.)		
UNIT PARTICULARS	CARPET	OPEN BAL.
801, 802, 803	73.00	5.50
804	71.00	3.90